

# BUILDING BLANKET



Glass wool building blanket is manufactured in three different types as 300, 350 and 400. It is used on the slabs of non utilized attics, between the rafters of utilized attics, for horizontal applications where no load is applied, for metal and sandwich roofs.

## Application

Building blankets are rolled out on the slab when they are used for the insulation of non utilized attics. Since glass wool building blanket is lightweight, it is easy to take it up to the roof and to cut to be applied. Owing to the characteristics of glass wool, it doesn't get ripped during application. It can be applied easily with no waste pieces and each piece can be utilized. It can be adjusted to any type of roof. In order to reduce the condensation risk in winter and to discharge the overheated air in the attic, upper part of the insulation should be kept ventilated. The rolls should not be covered over by nylon or similar type of covers. Aluminium foil faced building blankets should be rolled on in the manner that the foiled face will be on the warm inner side.

Building Blanket 300	Thickness (cm)	Width x Length (cm)	Package (m <sup>2</sup> )
	8	120 x 750	9,00
	10	120 x 600	7,20
	12	120 x 600	7,20
	14	120 x 600	7,20
	16	120 x 500	6,00
	18	120 x 500	6,00
	20	120 x 500	6,00

Building Blanket 350	Thickness (cm)	Width x Length (cm)	Package (m <sup>2</sup> )
	8	120 x 1000	12,00
	10	120 x 800	9,60
	12	120 x 600	7,20
	14	120 x 600	7,20
	16	120 x 500	6,00
	18	120 x 500	6,00
	20	120 x 500	6,00

Building Blanket 400	Thickness (cm)	Width x Length (cm)	Package (m <sup>2</sup> )
	10	120 x 800	9,60
	12	120 x 600	7,20
	14	120 x 600	7,20



- Thermal insulation
- Fire safety
- Sound insulation
- Easy to install
- Available in different sizes
- Lightweight



# TECHNICAL DATA SHEET

## Izocam Building Blanket

Properties		Symbol	Unit	Description						Tolerance	Standard	
Material Type		-	-	400 *	350	300						
Material		-	-	Glass Wool						-	TS EN 13162	
Declared Thermal Conductivity (10 °C)		$\lambda_D$	W/m.K	0,043	0,040	0,036				-	TS EN 12667/12939	
Width		w	mm	1200						+/-1,5%	TS EN 822	
Length		l	mm	10000	8000	6000	5000			+/-2%	TS EN 822	
Thickness		t	mm	80	100	120	140	160	180	200	T1 **	TS EN 823
Facing		-	-	Unfaced			Al-foil			-	-	
Reaction to fire		-	-	A1			C-s <sub>1</sub> ,d <sub>0</sub>			-	TS EN 13501-1	
Thermal Resistance	400	R <sub>D</sub>	m <sup>2</sup> .K/W	-	2,30	2,75	3,25	-	-	-	-	TS EN 13162
	350			2,00	2,50	3,00	3,50	4,00	4,50	5,00		
	300			2,20	2,75	3,30	3,85	4,40	5,00	5,55		
Specific Heat ***		c	kJ/(kg.K)	0,84						-	EN 12524	
Water Vapor Diffusion Resistance Coefficient ***		$\mu$	-	1			NPD			-	TS EN 12086	
Dynamic Elasticity ***		Edyn	kN/m <sup>2</sup>	0,8						-	DIN 52214	
Packaging Material		-	-	PE Film						-	-	
Other Information		Maximum service temperature on the side faced with aluminium foil is 90 °C.										

\* 80 mm thickness blanket for type 400, is not available.

\*\* T1: -5% or -5 mm, the biggest value is chosen at minus tolerance.

\*\*\*\* Declaration of licensor for equivalent products of Izocam.

### Safety Reminders for Loading, Unloading, Shipping and Storing

- These operations should be done indoors in case of rainy weather conditions.
- Loading and unloading should be done by (at least) two people.
- Products should be put on top of each other with extra care.
- Only backshutter of the truck body should be opened during unloading.
- Unloading should be carried out from backside to the front.
- Products should be wrapped by a waterproof cover even if the shipping distance is short.
- Products should not be put into upright position during shipping and storing.
- Storing should be carried out by using pallets. But they should not superposed with pallets.
- Products should not be pulled by their package.
- Products should not be stepped on and should not be used as steps.
- The packages should be put on the floor with extra care so the corners of the product especially is not damaged by a hit.

Izocam is not responsible for any problem because of misprinting. Izocam, the manufacturer, reserves the right to alter product specifications without prior notice. Izocam also manufactures special products upon request. For your requirements, you are requested to contact our Export Department.

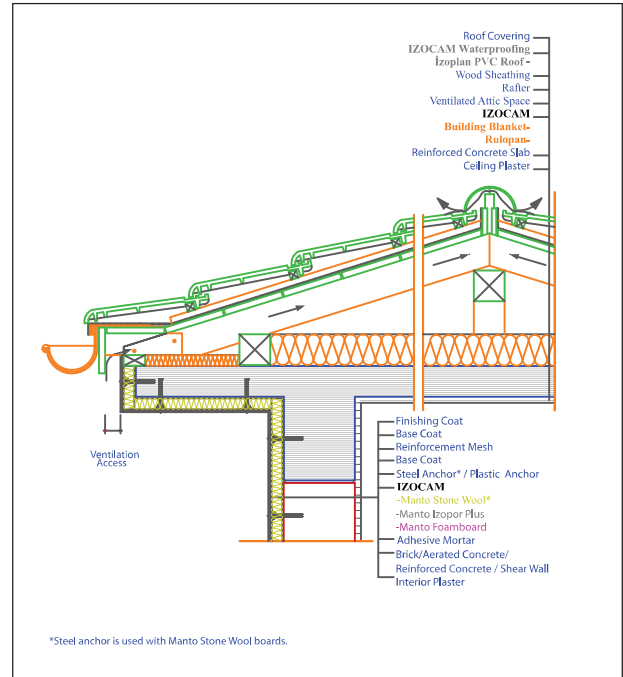

ENCYCS2018/11

