



PVC

Window & Door Hardwares

www.fornax.com.tr

Warning

All information contained in this catalog has been tried to keep up to date since the date of publication. Fornax is not responsible for the technical and legislative changes and product changes that may occur due to timeout that made after the date of publication. Errors that may arise in the case of printing and typesetting, the records in Fornax system will be considered.

All copying and distribution rights reserved.

Catalog printing date : 01.03.2020

**Yelken Kalıp Pencere Kapı Aksesuarları
ve Metal Sanayi Tic. A.Ş.**

Kırac Battalgazi Mah. Ahmet Hasim Cad. No: 27
Esenyurt - İstanbul - TURKEY

Phone : +90 212 771 01 01 PBX

Fax : +90 212 771 01 10

sales@fornax.com.tr

www.fornax.com.tr



Fornax Pvc
Yelken Kalıp Pencere Kapağı
Aks. ve Metal San. Tic. A.Ş.

50 years experience

Our story started in 1969 with our founder Mr. Süleyman YELKEN.

In the beginning years of our foundation; we have entered the industry with processing metal sheet.

Our company had adopted the principle of manufacturing at high standards and had been a sub-industry supplier to the world's giant brands in the 80's.

During the passing years we have strengthened our foundation with know-how and experience; and in 1990 we have started to be a competitive supplier in PVC window and door accessories.

Thanks to our mentality that consists of continuous progress; our journey which started with a single person; has lead us to becoming the leader company in the industry. During this period our company has continued its planned growth and development investments.

Following the 90's our company has doubled its investments in R&D and progress in such a short period of 10 years in order to increase its range of products to meet the demands of the market; and has achieved the capacity to produce all the hardware that the PVC door and window industry can require.

This period of progress has concluded in adding systems such as tilt & turn and double sash systems, door locking hardware, fastener equipment and door and window handles to our portfolio. We have also incorporated domestic and international quality certificates such as TSE, ISO-9001, LNE, RAL and GOST-R in order to register our quality.

Our company is continuing to invest in automation technologies; that is the vital necessity of our age. Our high quality production and principle of customer satisfaction has helped us in becoming a leader company in the world market.



Fornax Pvc Quality Certificates



Quality and Environmental Policy

Yelken Kalıp Pencere Kapı Aks. ve Metal Sanayi Tic. A.Ş. guarantees to fulfill the requirements of the quality standards ISO 9001:2008 and to provide quality products and services within this scope.

The company also certifies that it has established and is implementing a management system in accordance with the Quality management System standards.

The company sees environment protection as an inseparable piece as its institutional activities and shapes all its products and services in compliance with the protection of existing resources and the ecological balance.



Yelken Kalıp Pencere - Kapı
Aksesuarları ve Metal San. Tic. A.Ş.
Kıracı İstiklal Mahallesi/Altınmet Hacım
Cadde No : 27
Esenyurt / İSTANBUL - TÜRKİYE
Phone : +90 212 771 01 01
Fax : +90 212 771 01 15
sales@fornax.com.tr
www.fornax.com.tr

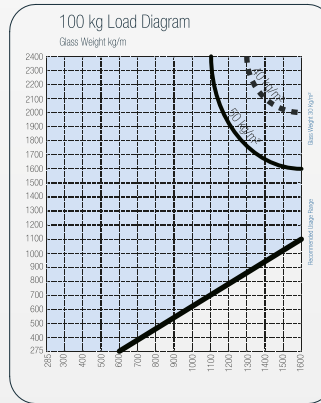
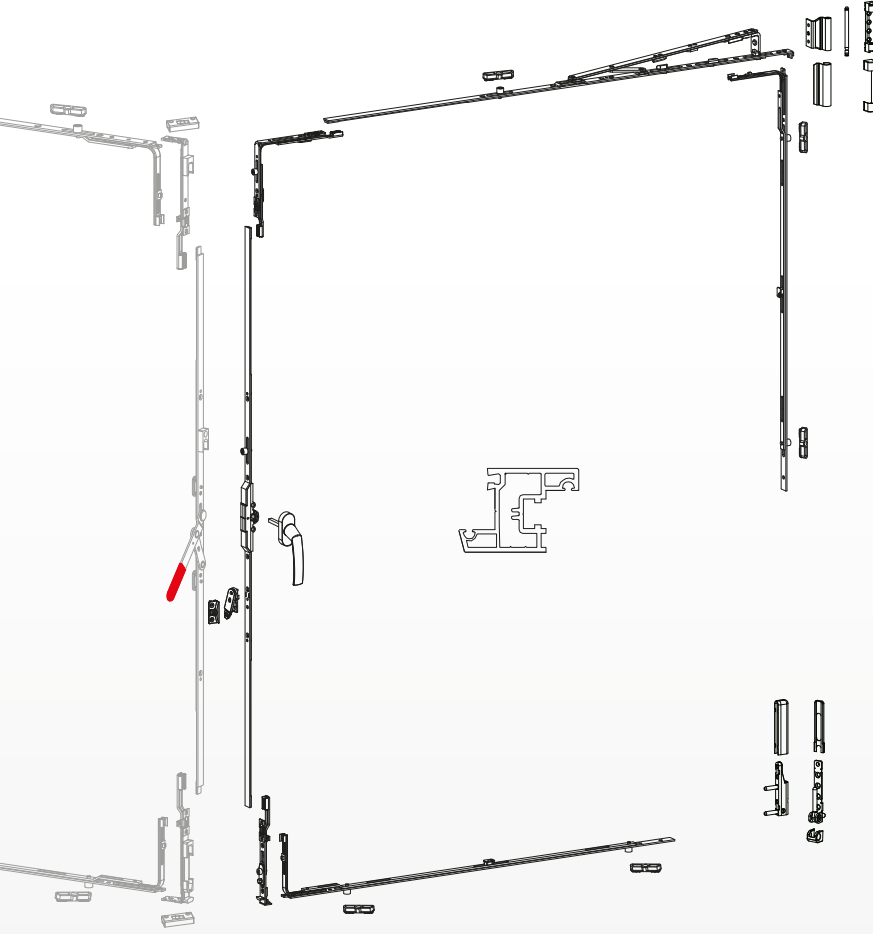

- Please contact your sales representative for your demands.

PVC
TILT & TURN HARDWARES
PTS-185

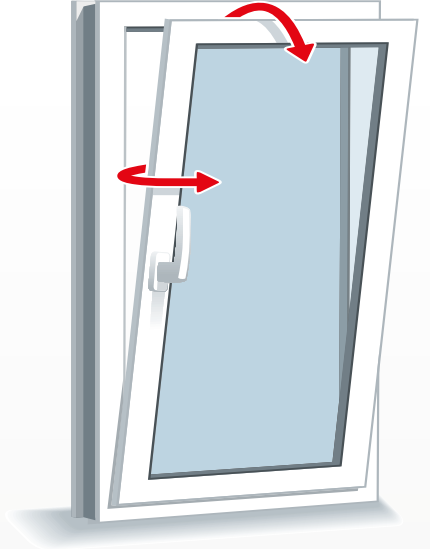

Technical Specifications

- Sash Width.....: 400mm - 1600*mm
- Sash Height.....: 480mm - 2400 mm
- Sash Weight.....: Max. 100 Kg

Color Options

- Our Standart Colors
- For other colors please ask your sales representative



Our Advantages

- Our system is suitable for Fixed Handle (FH) application.
- Carrying capacity is ideally suitable for tilt & turn, turn only and tilt only windows up to 100 kg. of sashes
- Saves time in installation.
- Our system has two type of hinge options including clipped and corner connection.
- Micro Ventilated Corner Transmission is available in our product portfolio.

PVC

TILT & TURN HARDWARES

TILT FIRST

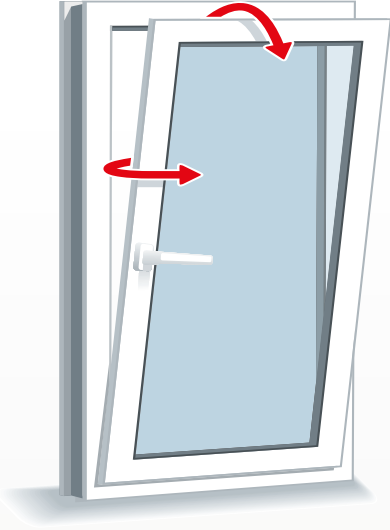

Technical Specifications

- Sash Width.....: 400mm - 1600*mm
- Sash Height.....: 480mm - 2400 mm
- Sash Weight.....: Max. 100 Kg

Color Options

- Our Standart Colors
For other colors please ask your sales representative



Our Advantages

- Our system is suitable for Fixed Handle (FH) application.
- Carrying capacity is ideally suitable for tilt & turn, turn only and tilt only windows up to 100 kg. of sashes
- Saves time in installation.
- Our system has two type of hinge options including clipped and corner connection.
- Micro Ventilated Corner Transmission is available in our product portfolio.

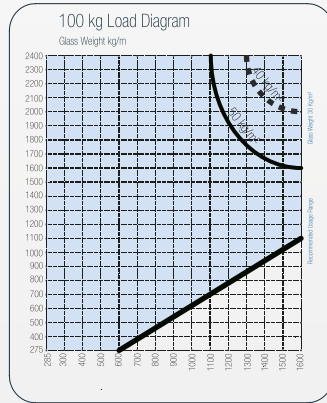
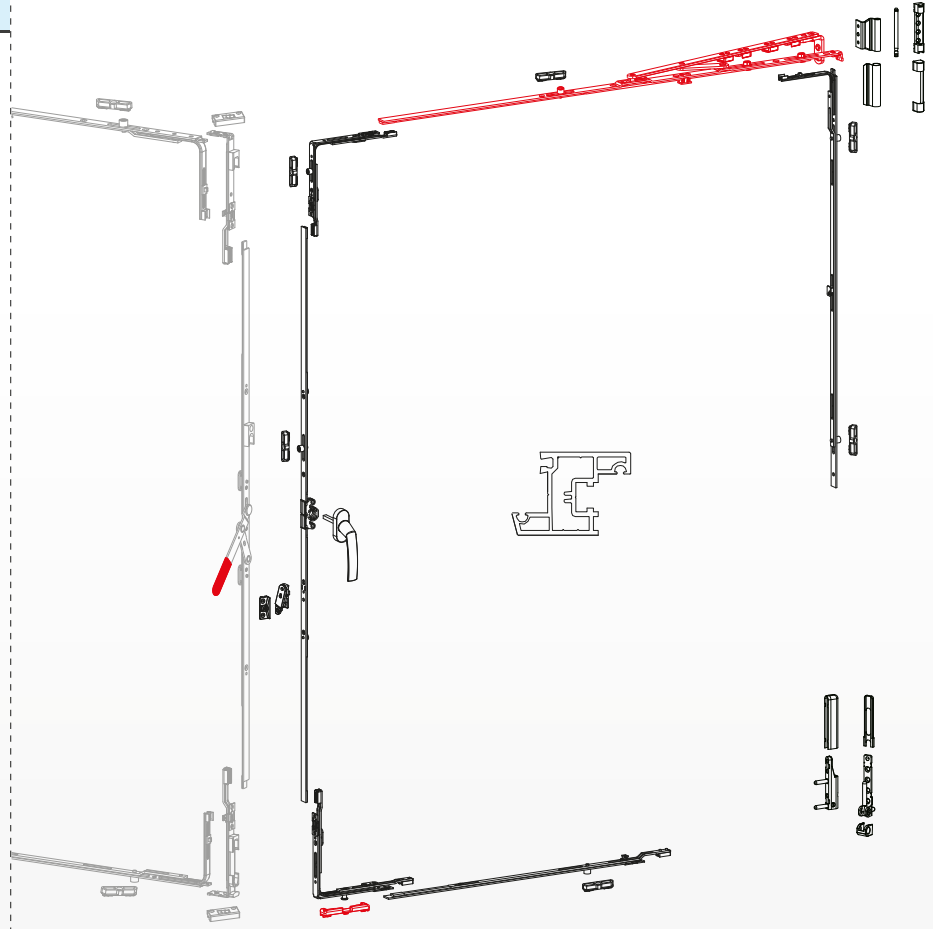

- Please contact your sales representative for your demands.

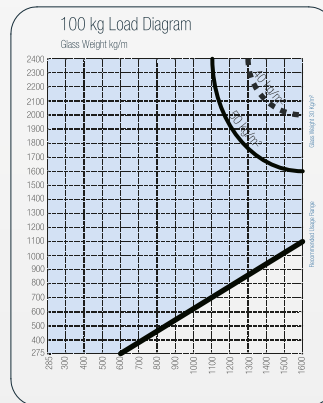
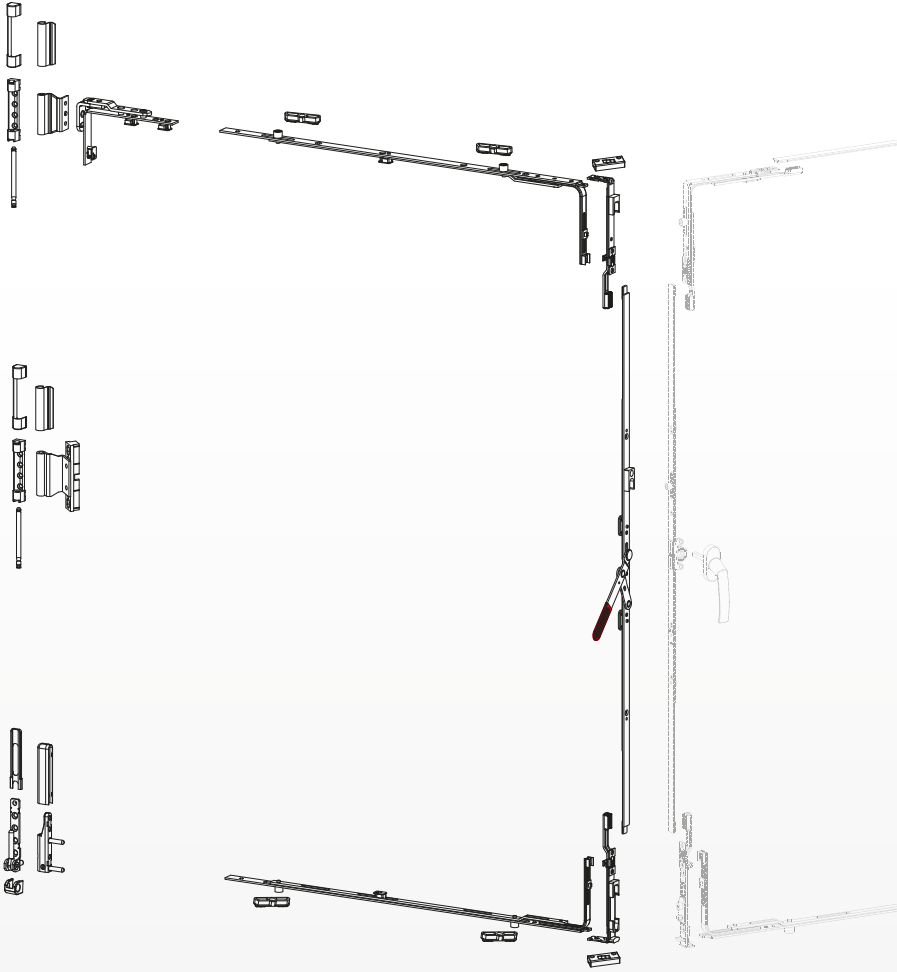

PVC
TILT & TURN / DOUBLE SASH
PTS-188

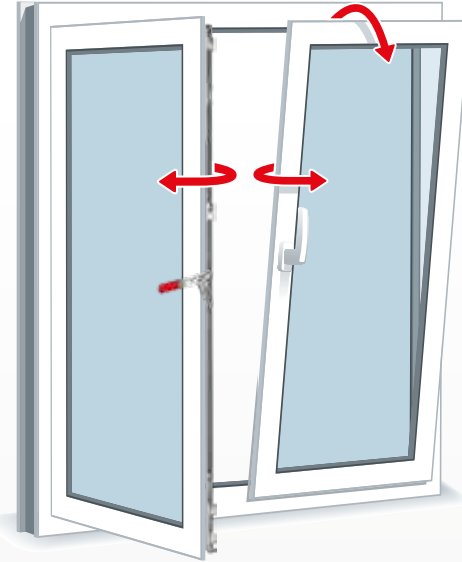

Technical Specifications

- Sash Width.....: 400mm - 1600*mm
- Sash Height.....: 480mm - 2400 mm
- Sash Weight.....: Max. 100 Kg

Color Options

- Our Standart Colors
- For other colors please ask your sales representative



Our Advantages

- Our system is suitable for Fixed Handle (FH) application.
- Carrying capacity is ideally suitable for tilt & turn, turn only and tilt only windows up to 100 kg. of sashes
- Saves time in installation.
- Our system has two type of hinge options including clipped and corner connection.
- Micro Ventilated Corner Transmission is available in our product portfolio.

- Please contact your sales representative for your demands.

PVC

DOUBLE SASH FOR DOOR

PTS-188

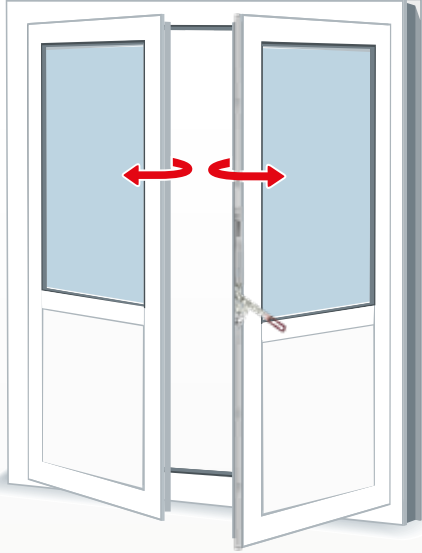

Technical Specifications

- Sash Width.....: 400mm - 1600*mm
- Sash Height.....: 480mm - 2400 mm
- Sash Weight.....: Max. 100 Kg

Color Options

- Our Standart Colors
- For other colors please ask your sales representative

Ral-9016	Ral-8003	Ral-8017	Ral-8019	Ral-8022	Ral-9006
----------	----------	----------	----------	----------	----------

Our Advantages

- Our system is suitable for Fixed Handle (FH) application.
- Carrying capacity is ideally suitable for tilt & turn, turn only and tilt only windows up to 100 kg. of sashes
- Saves time in installation.
- Our system has two type of hinge options including clipped and corner connection.
- Micro Ventilated Corner Transmission is available in our product portfolio.

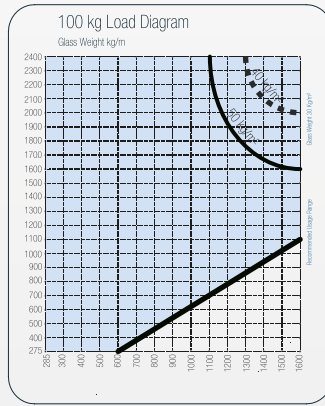
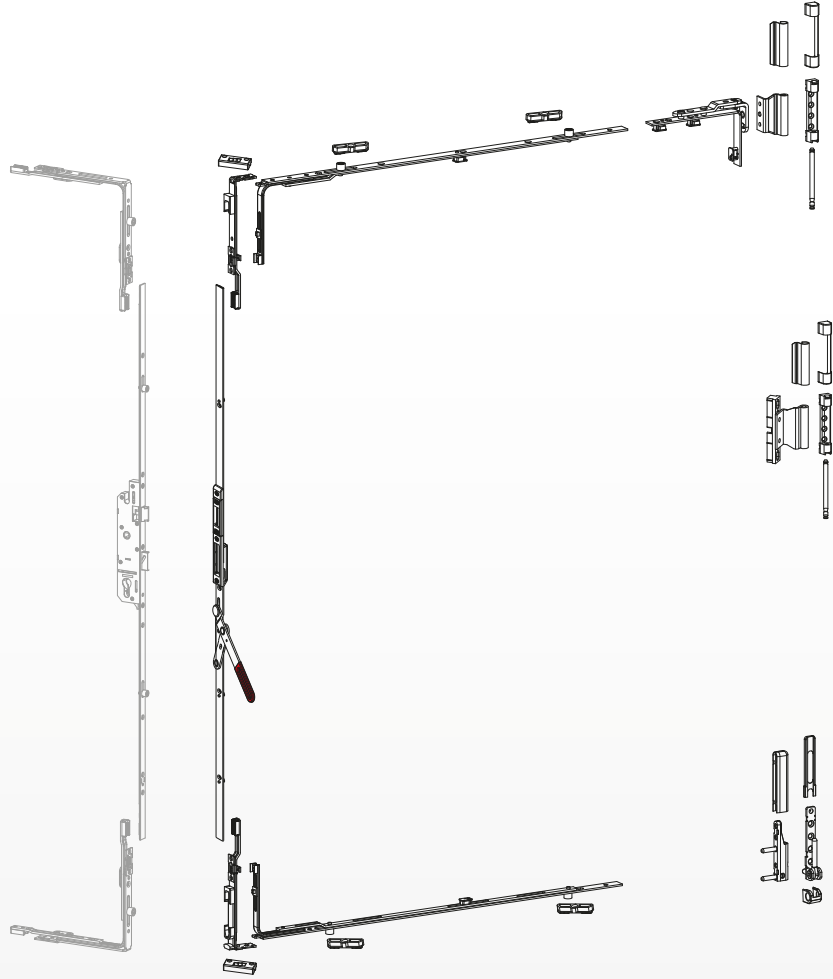

9-20 - 11,8
10-20 =
13-20 - 15,9
14-20 -
13-22 -

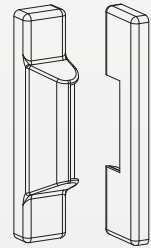
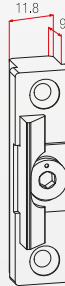

Covers For Central Hinge's Body

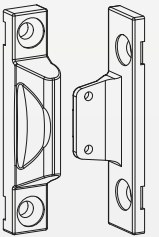

Central Hinge's Body

- Please contact your sales representative for your demands.

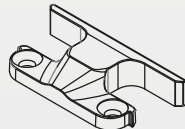

189165001000

Eccentric Pin Striker

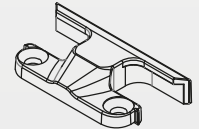

189165001100

Eccentric Pin Striker

PVC

OUTWARDING FRICTION STAY

AS - 499



Curtain Wall

The item is used for outward opening PVC windows. Our friction stays are made of stainless steel.

The outward opening window and the multipoint stay arm are installed to the frame. Both parts carry out the opening movement of the opening angle of the window and the opening of the sash up to a certain angle.

As a result the stay arm hinges and hinges provide the continuous movement and the visibility of the sash.

The stay arm type varies according to the weight, height and width of the sash.

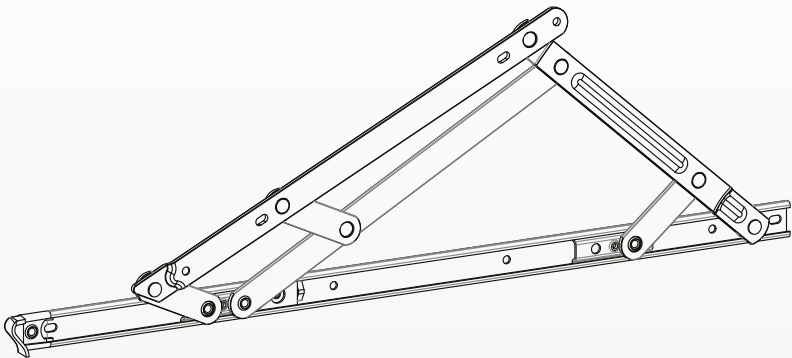

Outwarding friction stay

- KG - Sash Width..... 600mm - 1200mm
- KY - Sash Height 650mm - 1200mm
- TK.kg^{max} - Carrying Capacity Max. 18 - 28 kg
- GT - BodyType..... Stainless Steel
- Pins..... Stainless Steel

PVC

Code	Product Description			
499001001027	Stainless Friction Stay	8"	250mm	771000740
499001001028	Stainless Friction Stay	10"	250mm	772000740
499001001029	Stainless Friction Stay	12"	300mm	773000740
499001001030	Stainless Friction Stay	16"	400mm	774500740
499001001082	Stainless Friction Stay	20"	500mm	775000740
499001001083	Stainless Friction Stay	24"	600mm	776000740

Fornax PvcSlide LS-200/300 Lift Slide Systems

Big, Heavy and Aesthetic

Lift & Slide Systems are used for heavy and big sliding doors. They are the most important type of accessories due to their carrying capacities and dimensions.

The Lift & Slide Systems are very functional by means of providing a wide area for passage between spaces, for providing a wide view and for their availability in using more than one opening sash.

The Fornax LNS System has been designed for this type of profiles and provides a maximum efficiency in function for sashes up to 300 kg.

The Fornax LNS System produced from specially reinforced material; is a reason for preference thanks to its easy control and high security features.

The high quality and long lifetime of Fornax LNS will protect the elegance of your lift and slide profiles and maintain its functionality for many years to come.

Its Advantages

- There are 3 variations of espagnolettes according to doors and windows (25, 27,5 and 37,5)
- For bigger sizes; we have an optional additional roller with which the capacity can be increased up to 400 kg.
- Provides time saving in assembly, has been designed in order to prevent faulty installation.
- Provides microventilation with its microventilation striker.
- The tension spring is a standard feature in the handle.
- The 3,20 meter one-piece espagnolette provides locking at 4 points.
- Provides locking at 3 points in standard sizes.

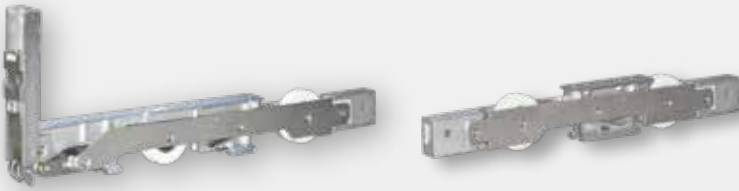

HANDLE

Kıvanç Series

Mısra Series



Pool Handle



Espagnolette

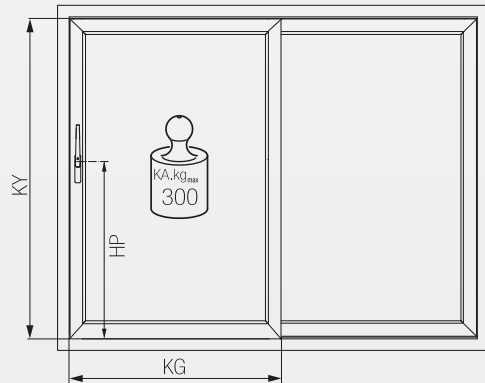

Technical Specifications

- Sash Width LS 200.....: 650 mm - 3200 mm
- Sash Width LS 300.....: 720 mm - 3200 mm
- Sash Height.....: 1200 mm - 3200 mm
- Sash Weight.....: max. 200 Kg / *300 Kg / *400 Kg
- Espagnolette Axis.....: 25 mm / 27,5 mm / 37,5 mm
- Handle Position.....: Window: 400 mm
Door : 1010 mm

Color Options

- Our Standard Colors
For other colors please ask your sales representative



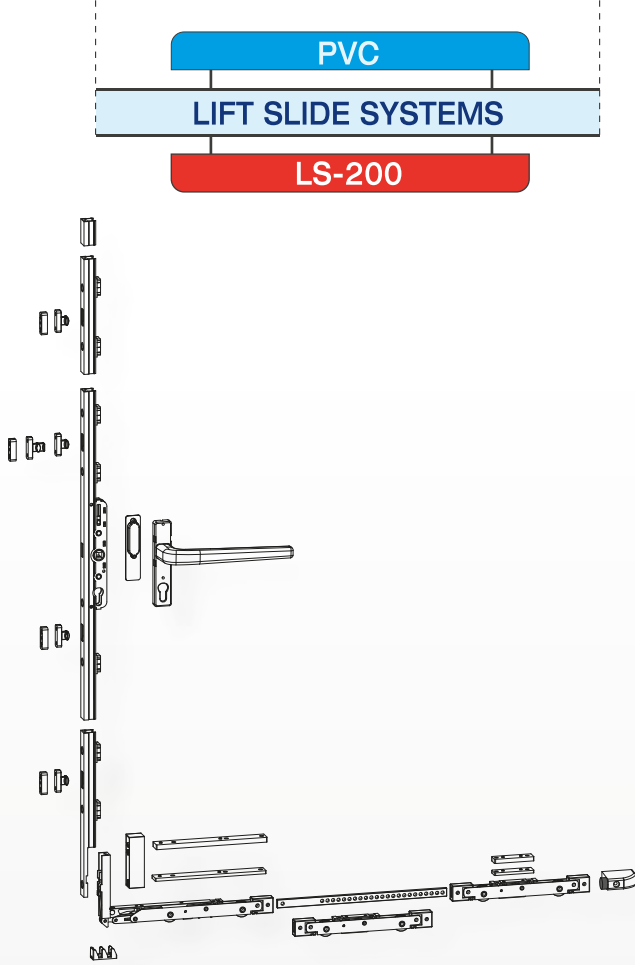

Order Details

27,5 mm Espagnolette		37,5 mm Espagnolette		Size	KA	Quantity
140.127.180.000		140.137.180.000	GR 01	1800	1200-1800	1 Pc
140.127.210.000		140.137.210.000	GR 02	2100	1801-2100	1 Pc
140.127.240.000		140.137.240.000	GR 03	2400	2101-2400	1 Pc
140.127.280.000		140.137.280.000	GR 04	2800	2401-2800	1 Pc
140.127.320.000		140.137.320.000	GR 05	3200	2801-3200	1 Pc
Connecting Road			Size	KA		Quantity
140.200.150.000	GR 01		900	720-1500		1 Pc
140.200.200.000	GR 02		1400	1501-2000		1 Pc
140.200.250.000	GR 03		1900	2001-2500		1 Pc
140.200.320.000	GR 04		2750	2501-3200		1 Pc
Handle Group						Quantity
140.301.000.100	Handle/ Withouth Cylinder					1 Set
140.301.000.200	Handle / With Cylinder					1 Set
140.302.000.100	Double Handle/ with Cylinder/ Knob					1 Set
140.302.000.200	Double Handle/ with and withouth cylinder					1 Set
200 Kg Accessories Group*						Quantity
140.401.000.001	Aluplast 70					1 Set
140.401.000.002	Aluplast HST 4000					1 Set
140.405.000.001	Deceuninck Monorial					1 Set
140.408.000.001	Gealan 8000					1 Set
140.412.000.001	Inotic Elit					1 Set
140.420.000.001	Profine Premidor					1 Set
140.421.000.001	Rehau Brillant					1 Set
140.421.000.002	Rehau Geneo					1 Set
140.421.000.003	Rehau S712					1 Set
140.422.000.001	Salamander					1 Set
140.422.000.002	Schüco Corona CT 70					1 Set
140.424.000.001	Thyssen HST					1 Set
140.424.000.002	Trocal S900					1 Set
140.427.000.001	Veka Slide					1 Set
140.427.000.002	Veka Softline					1 Set
140.427.000.003	Veka Topline					1 Set
140.428.000.001	Wymar 3000					1 Set

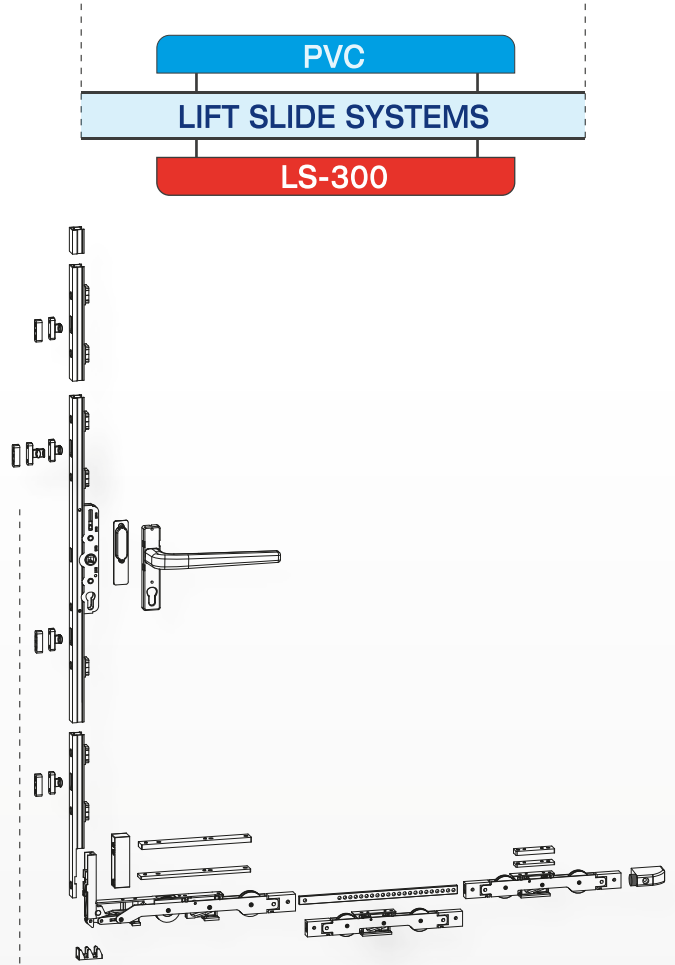

Order Details

27,5 mm Espagnolette	37,5 mm Espagnolette		Size	KA	Quantity
140.127.180.000	140.137.180.000	GR 01	1800	1200-1800	1 Pc
140.127.210.000	140.137.210.000	GR 02	2100	1801-2100	1 Pc
140.127.240.000	140.137.240.000	GR 03	2400	2101-2400	1 Pc
140.127.280.000	140.137.280.000	GR 04	2800	2401-2800	1 Pc
140.127.320.000	140.137.320.000	GR 05	3200	2801-3200	1 Pc
Connecting Road		Size	KA		Quantity
140.200.150.000	GR 01	900	720-1500		1 Pc
140.200.200.000	GR 02	1400	1501-2000		1 Pc
140.200.250.000	GR 03	1900	2001-2500		1 Pc
140.200.320.000	GR 04	2750	2501-3200		1 Pc
Handle Group					Quantity
140.301.000.100	Handle/ Withouth Cylinder				1 Set
140.301.000.200	Handle / With Cylinder				1 Set
140.302.000.100	Double Handle/ with Cylinder/ Knob				1 Set
140.302.000.200	Double Handle/ with and withouth cylinder				1 Set
140.305.000.100	LS-Dış Kol Büyük (B+)				1 Set
140.305.000.200	LS-Dış Kol Büyük (B-)				1 Set
140.308.000.100	LS-İç Kol Büyük (B+)				1 Set
140.308.000.200	LS-İç Kol Büyük (B-)				1 Set
300 Kg Accessories Group*					Quantity
140.501.000.001	Aluplast 70				1 Set
140.501.000.002	Aluplast HST 4000				1 Set
140.505.000.001	Deceuninck Monorial				1 Set
140.508.000.001	Gealan 8000				1 Set
140.512.000.001	Inotic Elit				1 Set
140.520.000.001	Profine Premidor				1 Set
140.521.000.001	Rehau Brilliant				1 Set
140.521.000.002	Rehau Geneo				1 Set
140.521.000.003	Rehau S712				1 Set
140.522.000.001	Salamander				1 Set
140.522.000.002	Schüco Corona CT 70				1 Set
140.524.000.001	Thyssen HST				1 Set
140.524.000.002	Trocal S900				1 Set
140.527.000.001	Veka Slide				1 Set
140.527.000.002	Veka Softline				1 Set
140.527.000.003	Veka Topline				1 Set
140.528.000.001	Wymar 3000				1 Set



Fornax PvcSlide TS-130

Prestige in Sliding Systems

The Fornax Parallel Sliding Systems; is a system developed for sliding door and window hardware that embodies the technology of Tilt & Turn systems and the elegance of Sliding systems.

It is the most effective and prestigious solution to the additional profile stock costs and insulation problems of simple sliding systems.

The system is available for use as single and double sashes. It creates a new alternative to the simple sliding systems with its easy and faultlessly installable equipment and parts, and provides an integrity with its superior quality and economical aspect.

The system provides an easy passage between places with the 1600mm opening it presents. It also provides a saving of space thanks to the technology of sliding systems.

The Parallel Sliding System provides easy passage to terraces, balconies, winter gardens and/or glassed sections; but is also an ideal solution for kitchens, study rooms and offices.

The system which as Manual and Semi-Automatic options can control sashes up to 130 kg and is able to provide ventilation without completely opening the sash.

Technical Specifications

- Sash Width: 500mm/700mm - 1600*mm
- Sash Height.....: 885mm - 2400 mm
- Frame Width.....: Max. 3200 mm
- Sash Weight.....: Max. 130 Kg

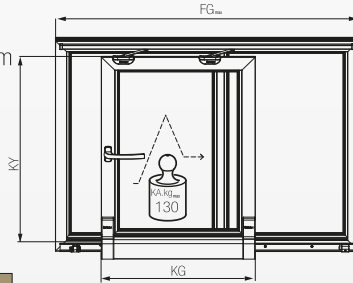

Color Options

- Our Standard Colors
For other colors please ask your sales representative



Our Advantages

- Our system provides usage possibility of 30/40 Aks.
Lockable CH Espagnolette.
- Carrying capacity for Sashes up to 130kg
- Saves time in installation. Has been designed to prevent faulty installation.
- Can be operated manually and semi-automatically.



Standard Stay Arm

Lux Stay Arm

PVC
PARALLEL SLIDING SYSTEMS
TS-130M MANUAL

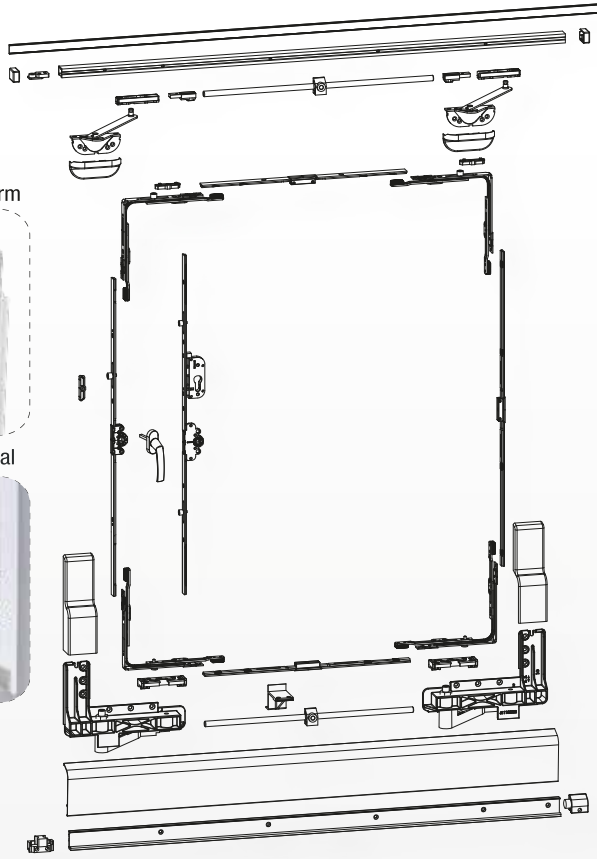

Standard Stay Arm

Manual

PVC
PARALLEL SLIDING SYSTEMS
TS-130ML LUX MANUAL

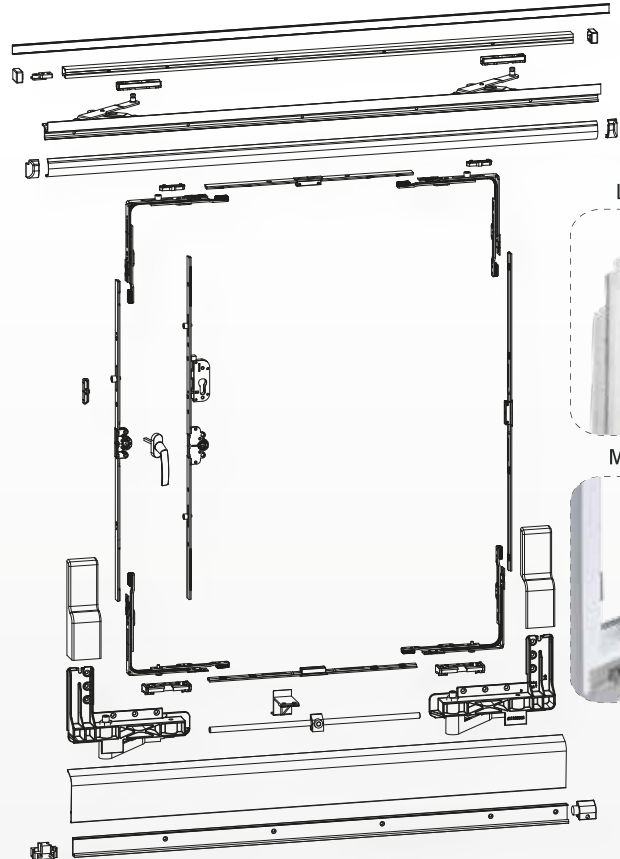

Lux Stay Arm





Manual



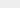

Order Details

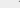
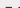
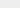
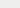
15mm Esp./Rail Set*	30mm Esp./Rail Set*		Vertical	Horizontal	Rail Size	Quantity
198.320.020.100		A200	885-1300	685-1100	2000	1 Set
198.320.020.200		B200	1185-1600	685-1100	2000	1 Set
198.320.020.300	198.320.120.300	C200	1585-2000	685-1100	2000	1 Set
198.320.020.400	198.320.120.400	D200	1985-2400	685-1100	2000	1 Set
198.320.026.100		A260	885-1300	885-1300	2600	1 Set
198.320.026.200		B260	1185-1600	885-1300	2600	1 Set
198.320.026.300	198.320.126.300	C260	1585-2000	885-1300	2600	1 Set
198.320.026.400	198.320.126.400	D260	1985-2400	885-1300	2600	1 Set
198.320.032.100		A320	885-1300	1185-1600	3200	1 Set
198.320.032.200		B320	1185-1600	1185-1600	3200	1 Set
198.320.032.300	198.320.132.300	C320	1585-2000	1185-1600	3200	1 Set
198.320.032.400	198.320.132.400	D320	1985-2400	1185-1600	3200	1 Set

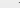
Order Details

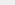
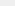
15mm Esp./Rail Set*	30mm Esp./Rail Set*		Vertical	Horizontal	Rail Size	Quantity
197.320.020.100		A200	885-1300	685-1100	2000	1 Set
197.320.020.200		B200	1185-1600	685-1100	2000	1 Set
197.320.020.300	197.320.120.300	C200	1585-2000	685-1100	2000	1 Set
197.320.020.400	197.320.120.400	D200	1985-2400	685-1100	2000	1 Set
197.320.026.100		A260	885-1300	885-1300	2600	1 Set
197.320.026.200		B260	1185-1600	885-1300	2600	1 Set
197.320.026.300	197.320.126.300	C260	1585-2000	885-1300	2600	1 Set
197.320.026.400	197.320.126.400	D260	1985-2400	885-1300	2600	1 Set
197.320.032.100		A320	885-1300	1185-1600	3200	1 Set
197.320.032.200		B320	1185-1600	1185-1600	3200	1 Set
197.320.032.300	197.320.132.300	C320	1585-2000	1185-1600	3200	1 Set
197.320.032.400	197.320.132.400	D320	1985-2400	1185-1600	3200	1 Set

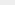
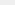
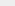
Accessories Set**		Handle	Axis	Left/Right	Quantity
198.331.200.000	130M		9	Right	1 Set
198.331.200.100	130M		13	Right	1 Set
198.331.300.000	130M		9	Left	1 Set
198.331.300.100	130M		13	Left	1 Set
198.332.200.000	130M		9	Right	1 Set
198.332.200.100	130M		13	Right	1 Set
198.332.300.000	130M		9	Left	1 Set
198.332.300.100	130M		13	Left	1 Set

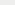
Accessories Set**		Handle	Axis	Left/Right	Quantity
197.331.200.000	130ML		9	Right	1 Set
197.331.200.100	130ML		13	Right	1 Set
197.331.300.000	130ML		9	Left	1 Set
197.331.300.100	130ML		13	Left	1 Set
197.332.200.000	130ML		9	Right	1 Set
197.332.200.100	130ML		13	Right	1 Set
197.332.300.000	130ML		9	Left	1 Set
197.332.300.100	130ML		13	Left	1 Set

PVC
PARALLEL SLIDING SYSTEMS
TS-130Y SEMI-AUTOMATIC

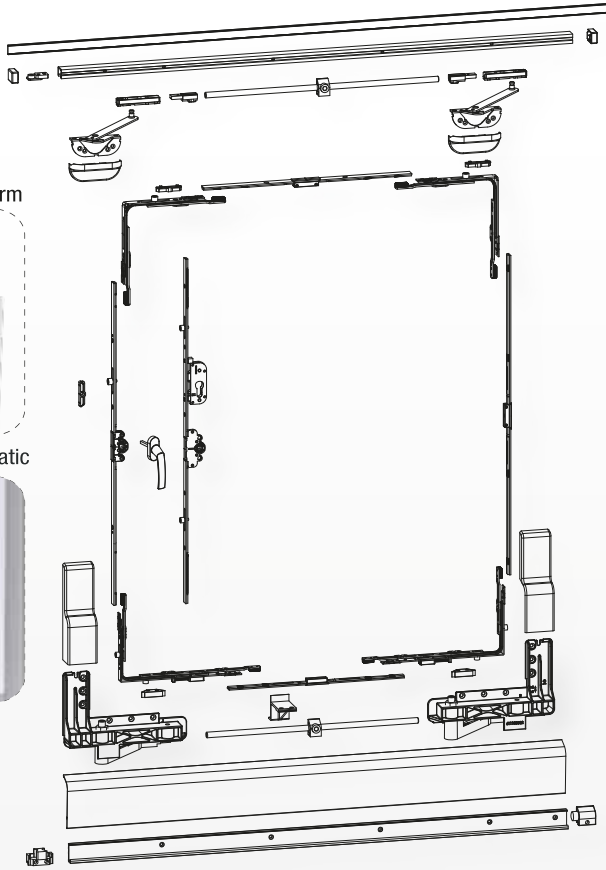

Standard Stay Arm

Semi-Automatic

PVC
PARALLEL SLIDING SYSTEMS
TS-130YL LUX SEMI-AUTOMATIC

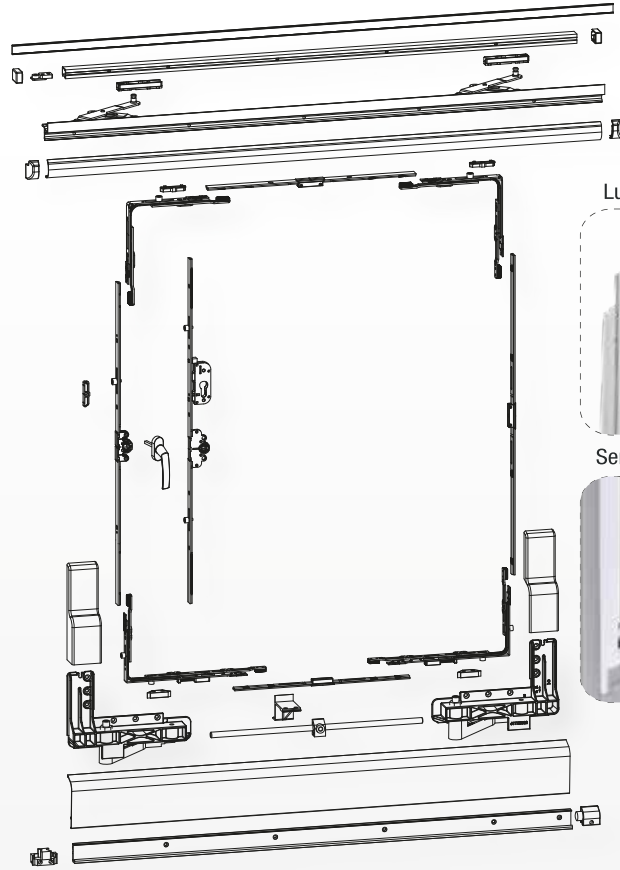

Lux Stay Arm

Semi-Automatic

Order Details

15mm Esp./Rail Set*	30mm Esp./Rail Set*		Vertical	Horizontal	Rail Size	Quantity
198.120.020.100		A200	885-1300	685-1100	2000	1 Set
198.120.020.200		B200	1185-1600	685-1100	2000	1 Set
198.120.020.300	198.120.120.300	C200	1585-2000	685-1100	2000	1 Set
198.120.020.400	198.120.120.400	D200	1985-2400	685-1100	2000	1 Set
198.120.026.100		A260	885-1300	885-1300	2600	1 Set
198.120.026.200		B260	1185-1600	885-1300	2600	1 Set
198.120.026.300	198.120.126.300	C260	1585-2000	885-1300	2600	1 Set
198.120.026.400	198.120.126.400	D260	1985-2400	885-1300	2600	1 Set
198.120.032.100		A320	885-1300	1185-1600	3200	1 Set
198.120.032.200		B320	1185-1600	1185-1600	3200	1 Set
198.120.032.300	198.120.132.300	C320	1585-2000	1185-1600	3200	1 Set
198.120.032.400	198.120.132.400	D320	1985-2400	1185-1600	3200	1 Set
Accessories Set**	Handle	Axis	Left/Right			Quantity
198.131.200.000	130Y	9	Right			1 Set
198.131.200.100	130Y	13	Right			1 Set
198.131.300.000	130Y	9	Left			1 Set
198.131.300.100	130Y	13	Left			1 Set
198.132.200.000	130Y	9	Right			1 Set
198.132.200.100	130Y	13	Right			1 Set
198.132.300.000	130Y	9	Left			1 Set
198.132.300.100	130Y	13	Left			1 Set

Order Details

15mm Esp./Rail Set*	30mm Esp./Rail Set*		Vertical	Horizontal	Rail Size	Quantity
197.120.020.100		A200	885-1300	685-1100	2000	1 Set
197.120.020.200		B200	1185-1600	685-1100	2000	1 Set
197.120.020.300	197.120.120.300	C200	1585-2000	685-1100	2000	1 Set
197.120.020.400	197.120.120.400	D200	1985-2400	685-1100	2000	1 Set
197.120.026.100		A260	885-1300	885-1300	2600	1 Set
197.120.026.200		B260	1185-1600	885-1300	2600	1 Set
197.120.026.300	197.120.126.300	C260	1585-2000	885-1300	2600	1 Set
197.120.026.400	197.120.126.400	D260	1985-2400	885-1300	2600	1 Set
197.120.032.100		A320	885-1300	1185-1600	3200	1 Set
197.120.032.200		B320	1185-1600	1185-1600	3200	1 Set
197.120.032.300	197.120.132.300	C320	1585-2000	1185-1600	3200	1 Set
197.120.032.400	197.120.132.400	D320	1985-2400	1185-1600	3200	1 Set
Accessories Set**	Handle	Axis	Left/Right			Quantity
197.131.200.000	130YL	9	Sag			1 Set
197.131.200.100	130YL	13	Sag			1 Set
197.131.300.000	130YL	9	Sol			1 Set
197.131.300.100	130YL	13	Sol			1 Set
197.132.200.000	130YL	9	Sag			1 Set
197.132.200.100	130YL	13	Sag			1 Set
197.132.300.000	130YL	9	Sol			1 Set
197.132.300.100	130YL	13	Sol			1 Set

PVC
PARALLEL SLIDING SYSTEMS
TS-130K CLASSIC

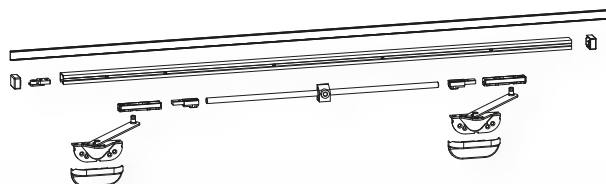

Standard Stay Arm

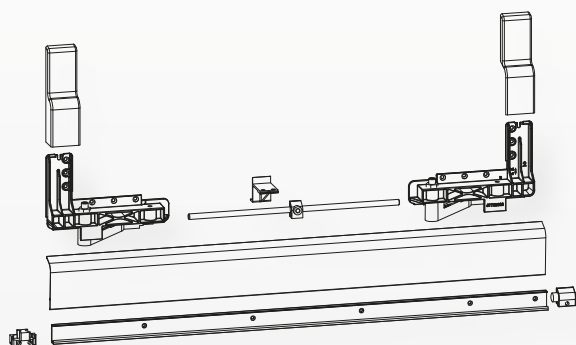

PVC
PARALLEL SLIDING SYSTEMS
TS-130KL LUX CLASSIC

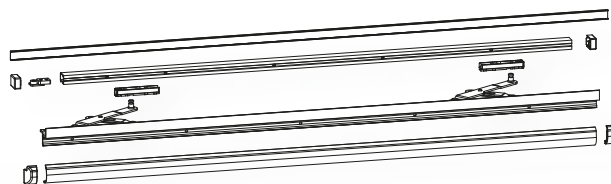

Lux Stay Arm

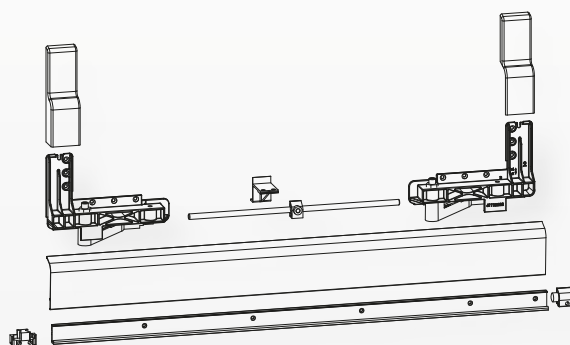

Order Details

Rail Set*	Rail Size		Quantity
198.410.020.000	A200	2000	1 Set
198.410.026.000	A260	2600	1 Set
198.410.032.000	A320	3200	1 Set
Accessories Set**	Handle	Left/Right	Quantity
198.431.200.000	130K	Right	1 Set
198.432.200.000	130K	Right	1 Set
198.431.300.000	130K	Left	1 Set
198.432.300.000	130K	Left	1 Set

Order Details

Rail Set*	Rail Size		Quantity
197.410.020.000	A200	2000	1 Set
197.410.026.000	A260	2600	1 Set
197.410.032.000	A320	3200	1 Set
Accessories Set**	Handle	Left/Right	Quantity
197.431.200.000	130KL	Right	1 Set
197.432.200.100	130KL	Left	1 Set
197.431.300.000	130KL	Right	1 Set
197.432.300.100	130KL	Left	1 Set