

Pelsan

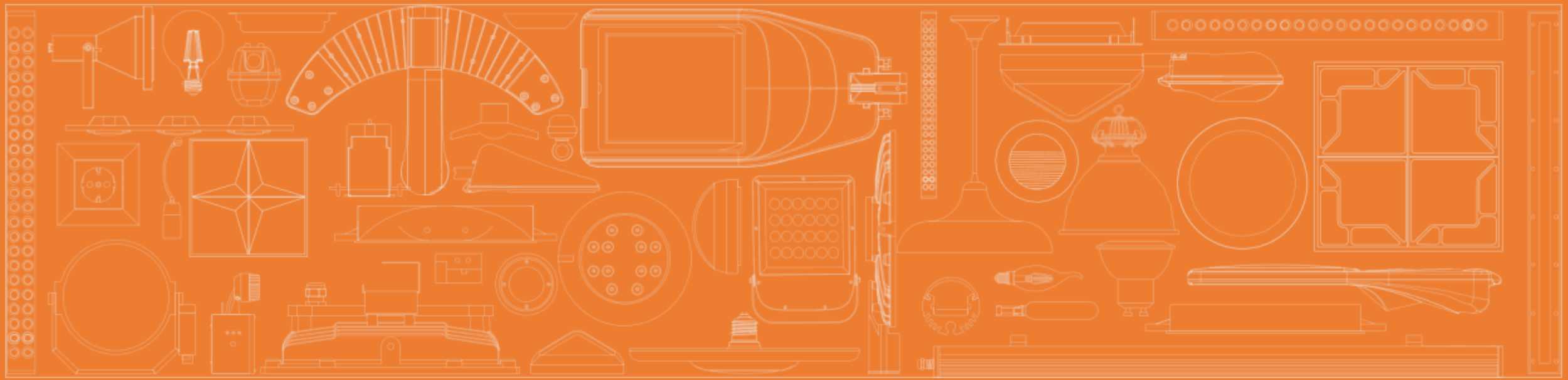



Pelsan Aydınlatma A.Ş.

A Brief Portrait

Milestones





38

Years of Experience



30.000 m²

Biggest Manufacturer
in Turkey



+350

Employees



3.000

SKU Products



5.000.000

Annual Quantity



7

Distribution Channels



47

Export Countries



23

Nr. of Different Standards
at Pelsan Lighting
Laboratory





System and Product Certificates



Achieved Accreditation by Turkish Accreditation Institution.



System and Product Certificates

Achieved Accreditation by Turkish Accreditation Institution.



System and Product Certificates



ACCORDING to
TS EN 60598-1
TS EN 60598-2
STANDARDS FIXTURE TESTS,

ACCORDING to
TS EN 13032-1
TS EN 13032-2
STANDARDS for Light and lighting.
Measurement and presentation of
photometric data of lamps and luminaires.

ACCORDING to
IESNA LM-79-08
STANDARD for ELECTRICAL AND
PHOTOMETRIC DATA MEASUREMENT

ACCORDING to
TS EN 62031
STANDARD for LED general lighting.
Safety specifications



ACCORDING to
TS EN 61347-2-13
STANDARD for Particular requirements for d.c. or
a.c. supplied electronic controlgear for LED modules

ACCORDING to
TS 3033 EN 60529
STANDARD for Degrees of protection provided
by enclosures (IP code)

ACCORDING to
TS EN 60695-2-10
TS EN 60695-2-11
TS EN 60695-2-12
TS EN 60695-2-13
TS EN 60695-11-5
STANDARDS for Fire hazard testing.
Glowing/hot-wire based test methods.
Glow-wire flammability test method
for end-products (GWEPT)



ACCORDING to
TS EN 60112
STANDARD for Method for the determination of the
proof and the comparative tracking indices of solid
insulating materials

ACCORDING to
TS EN 62262
STANDARD for Degrees of protection
provided by enclosures for electrical equipment a
gainst external mechanical impacts (IK code)

ACCORDING to
TS EN 60068-2-75
TS EN 60068-1
STANDARD for Environmental testing



Innovative & Environment Friendly Products



Fixtures with High Energy Efficiency and Long Lifetime designed and manufactured by PELSAN.

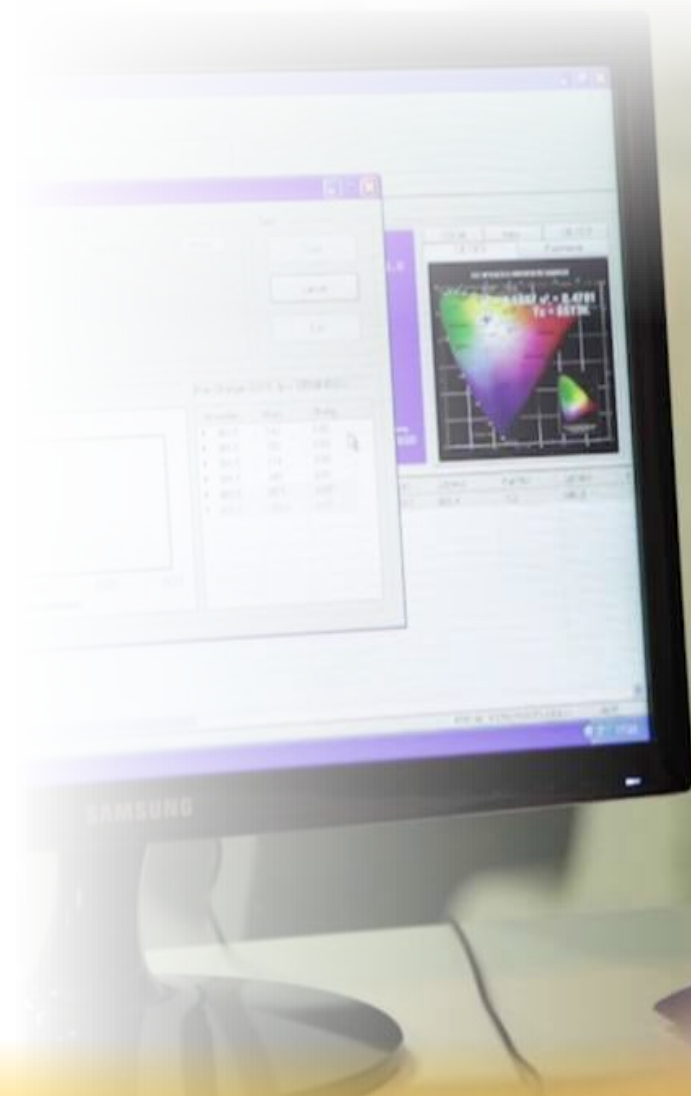

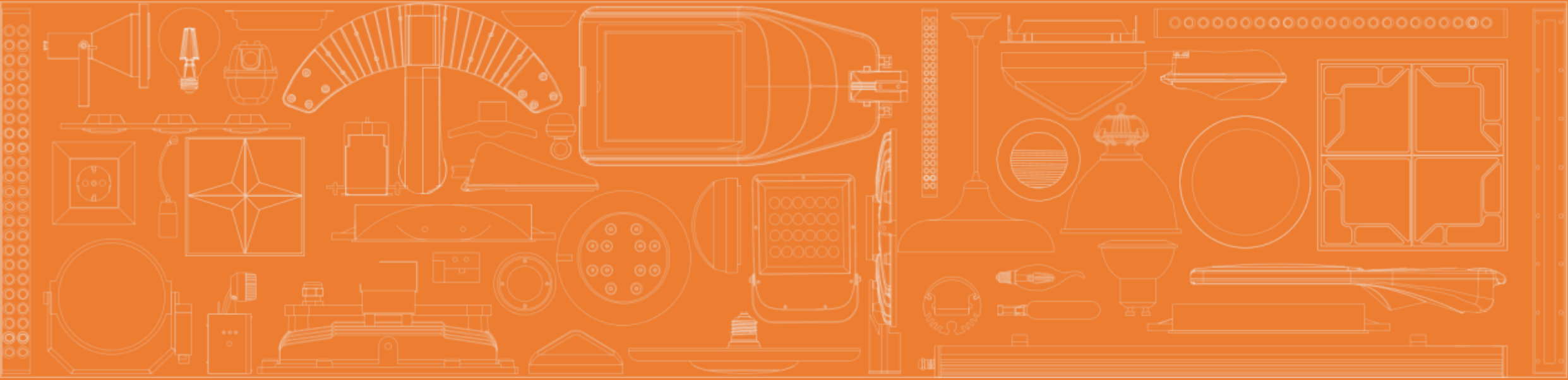

Production & Product Range

Factory

Product Range

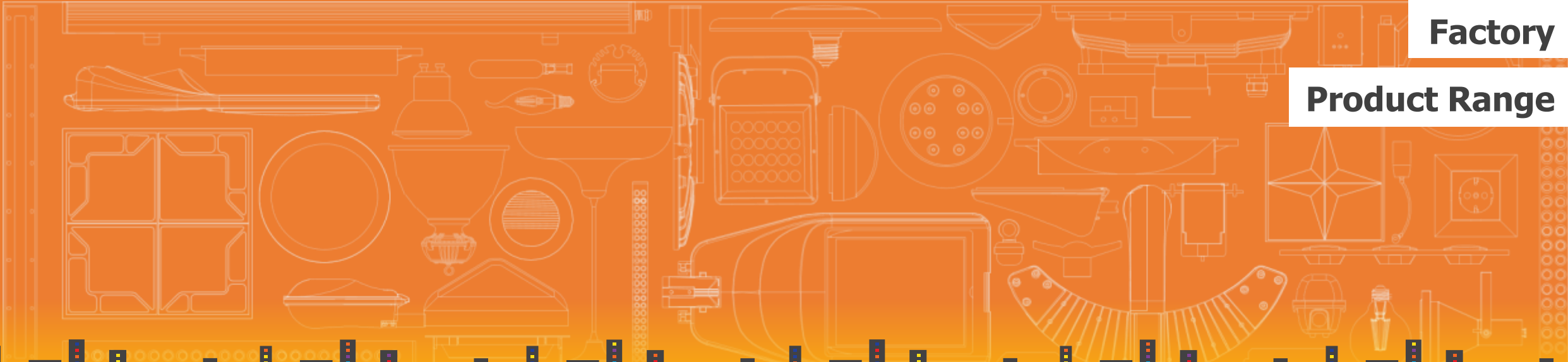

Our Own Facility at Gebze Imes Industrial Zone



- 30.000m² Indoor Production Area
- 1000m² Showroom
- 500m² Accredited Laboratory
- 250m² R&D Centre
- 10 Truck Containers Full Load&Depart Capacity Per Day
- 26.500m² Outdoor Social Area



Factory



R&D Center



Production

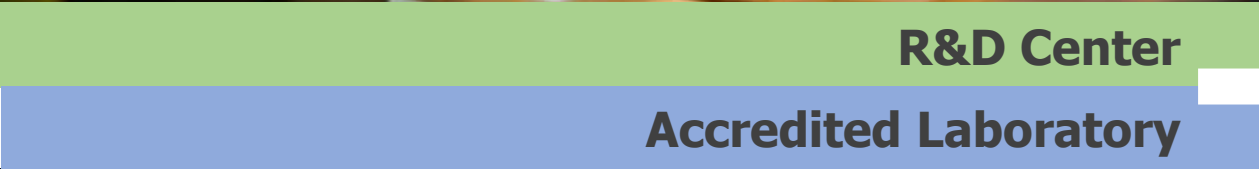

Accredited Laboratory



Logistic Area



● Electronic Assembly Line

- SMD Assembly Line – Full ESD – EPA Zone
- LED Assembly Line
- 35W-1000W Ignitor Manufacturing
- Emergency Converter Kit Manufacturing

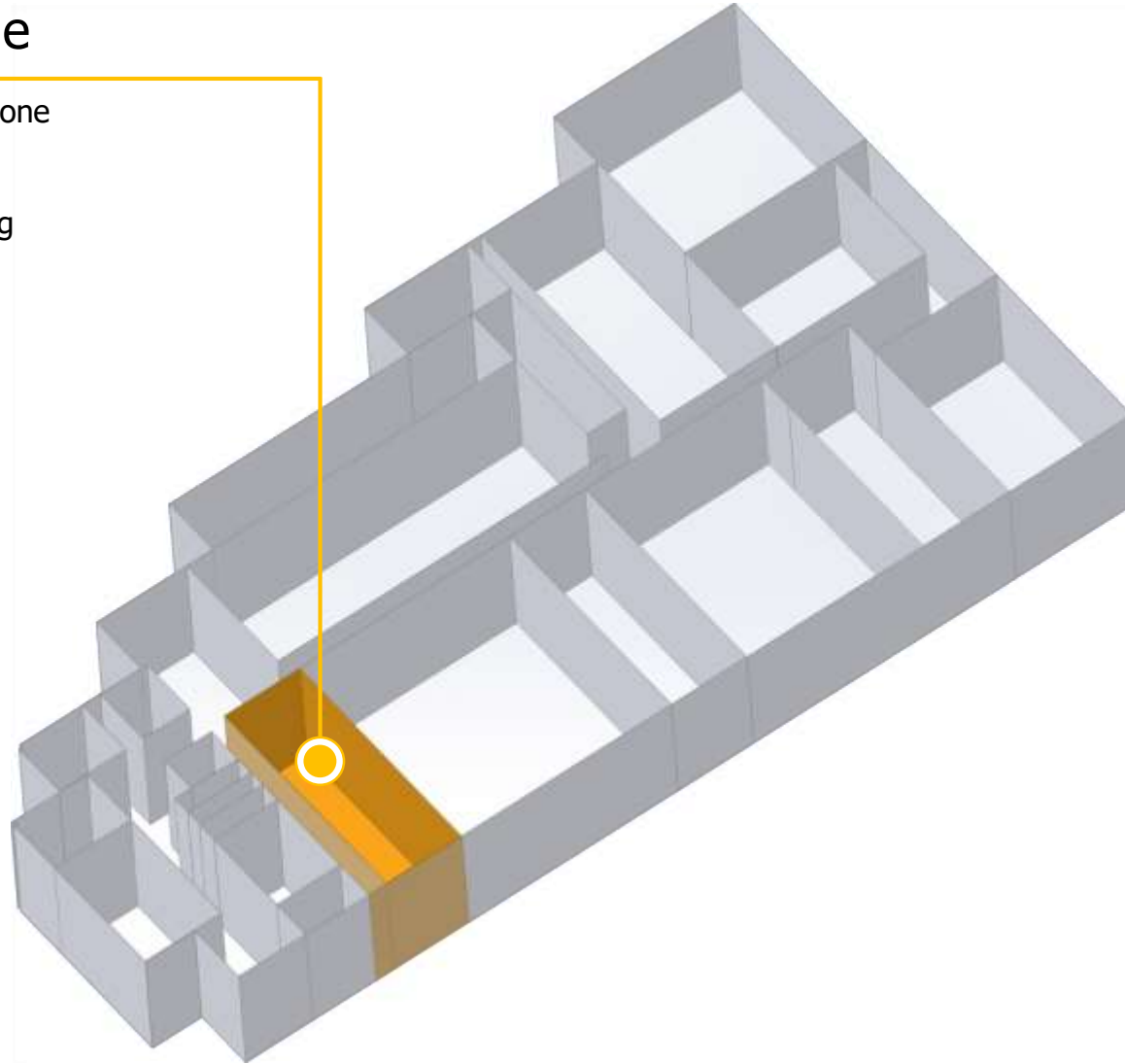

● Electronic Assembly Line

● Plastic Injection Moulding Area

- Street Lighting Fixtures
- Waterproof Fixtures Body and Diffusers
- Switches and Sockets
- Ceiling Luminaires
- Group Plug
- Floodlight Parts

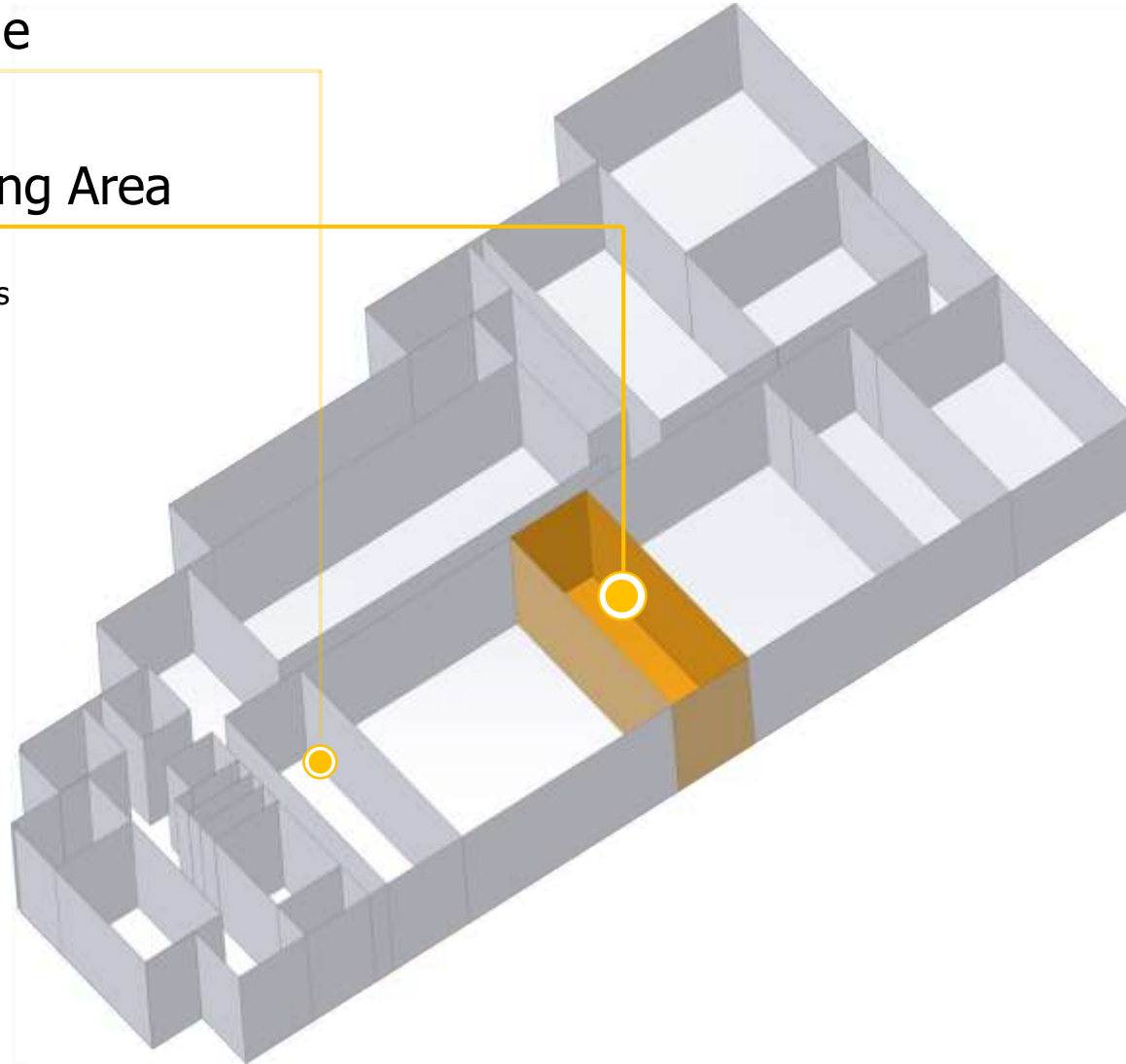

● Electronic Assembly Line

● Plastic Injection Moulding Area

● Semi-finished Goods Process Area

- Cut – Bend – Drill Process
- Spot Welding & Dry Welding Process
- Sth Plastering & Curler

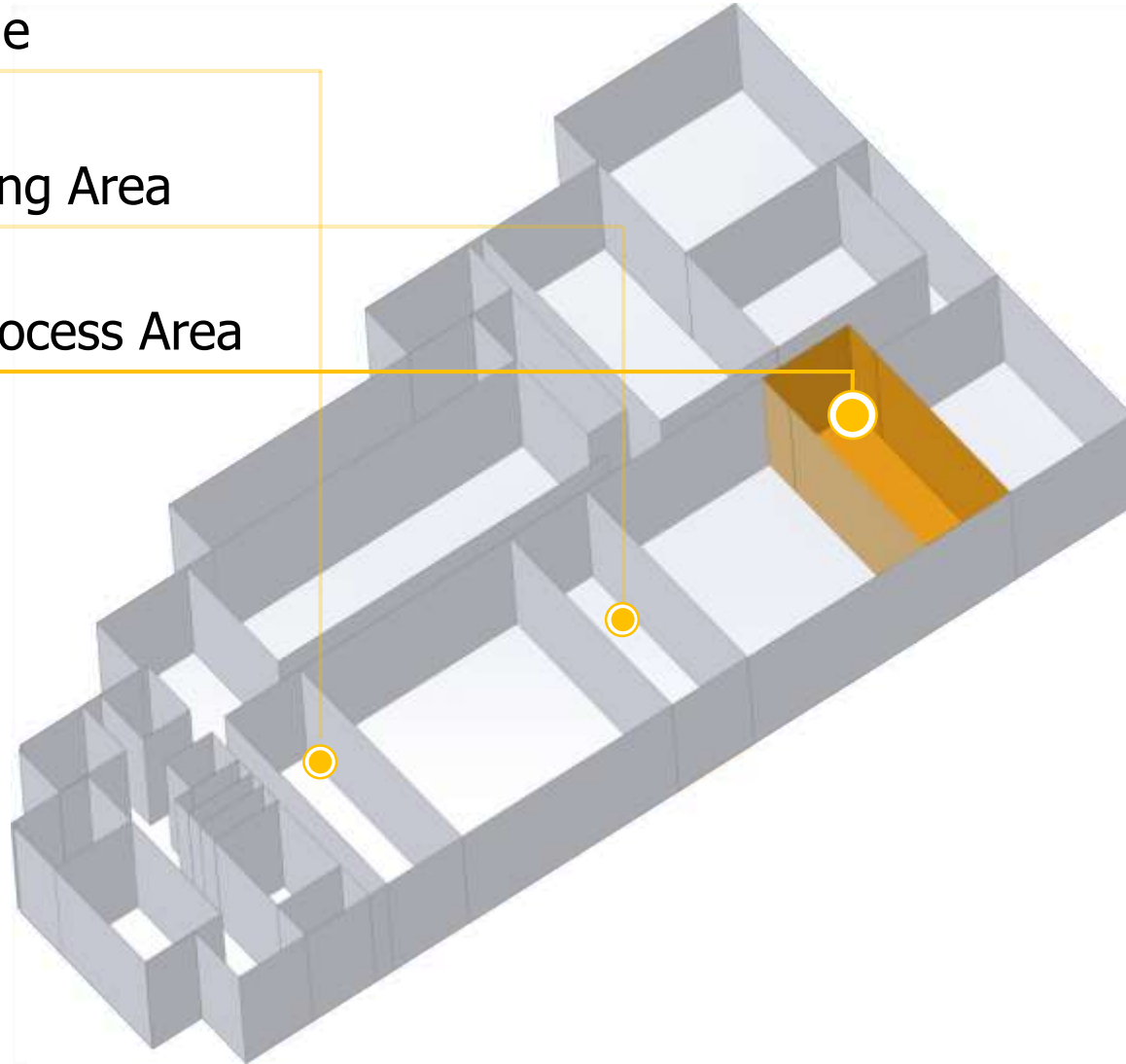

Factory

● Electronic Assembly Line

● Plastic Injection Moulding Area

● Semi-finished Goods Process Area

● Moulding Area

- Aluminium Moulding & Injection & Die Cast Process
- Plastic Injection Moulding
- Cut,Bend,Drill & Plastering Mould
- Thermo-set Moulding
- Maintenance & Handling Team

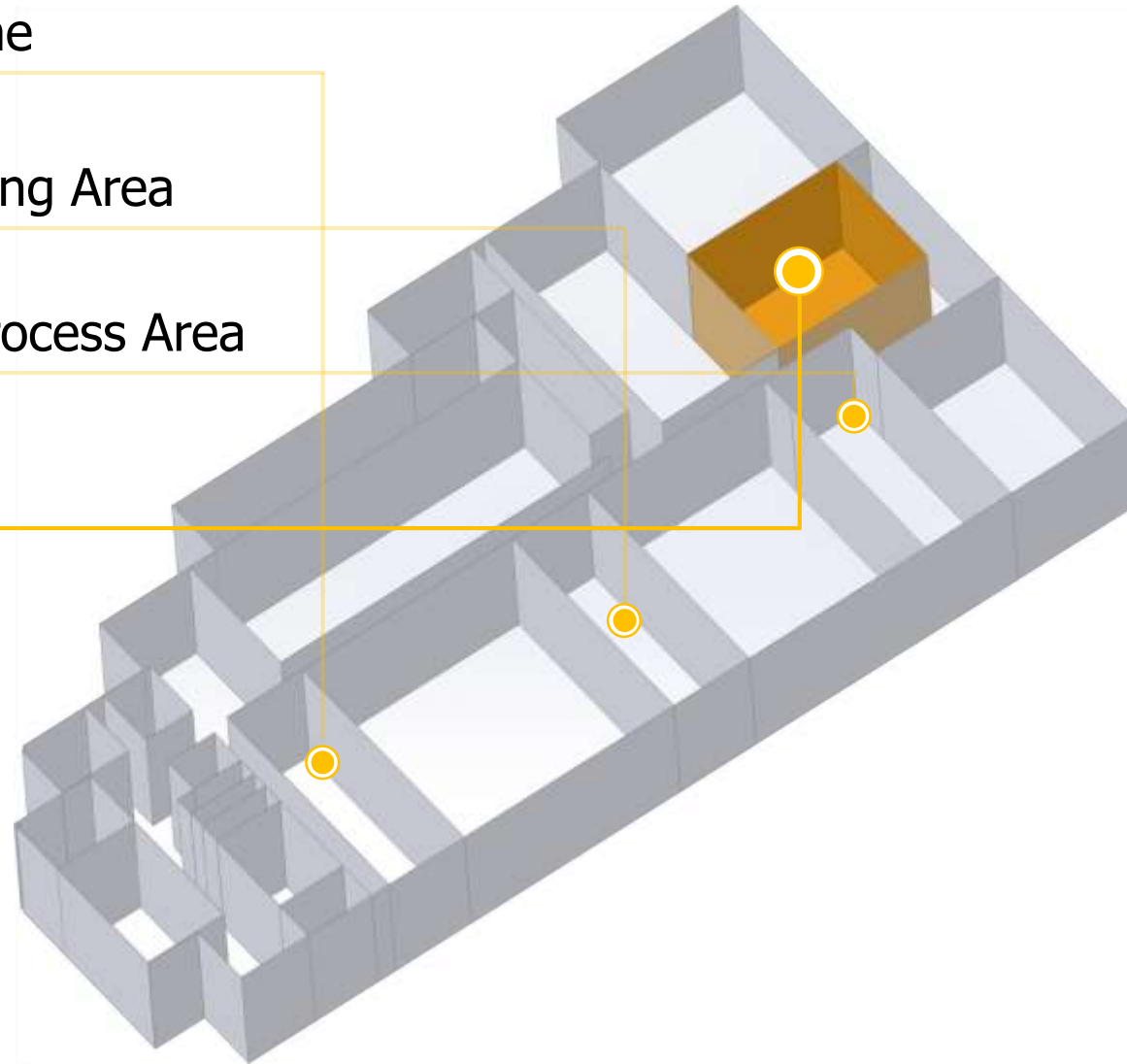

Factory

● Electronic Assembly Line

● Plastic Injection Moulding Area

● Semi-finished Goods Process Area

● Moulding Area

● Diffuser Treatment Area

- PC/PMMA/PS Diffuser Plate Sizing
- Diffuser Curving Process
- Pantograph Process

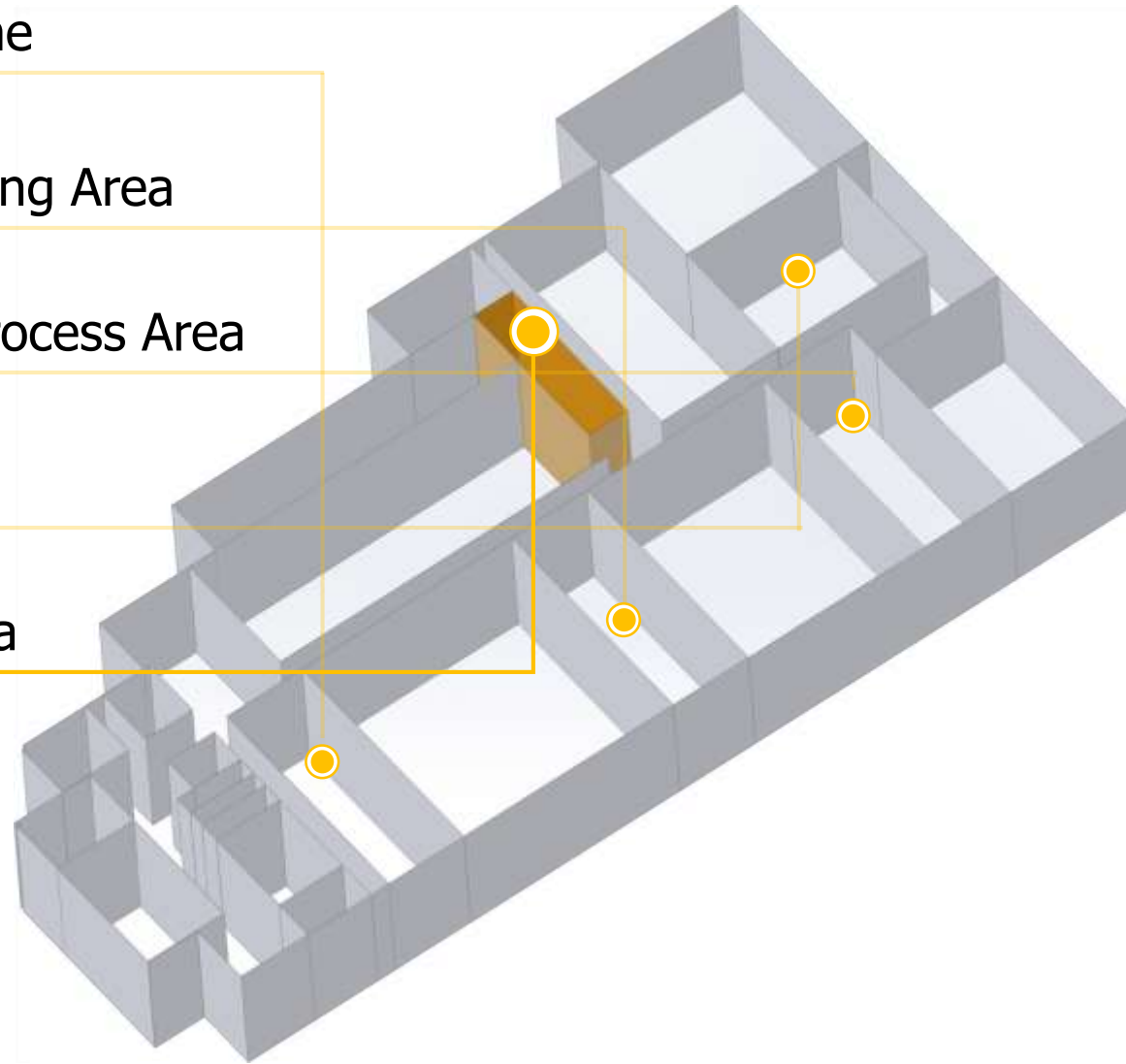

Factory

● Electronic Assembly Line

● Plastic Injection Moulding Area

● Semi-finished Goods Process Area

● Moulding Area

● Diffuser Treatment Area

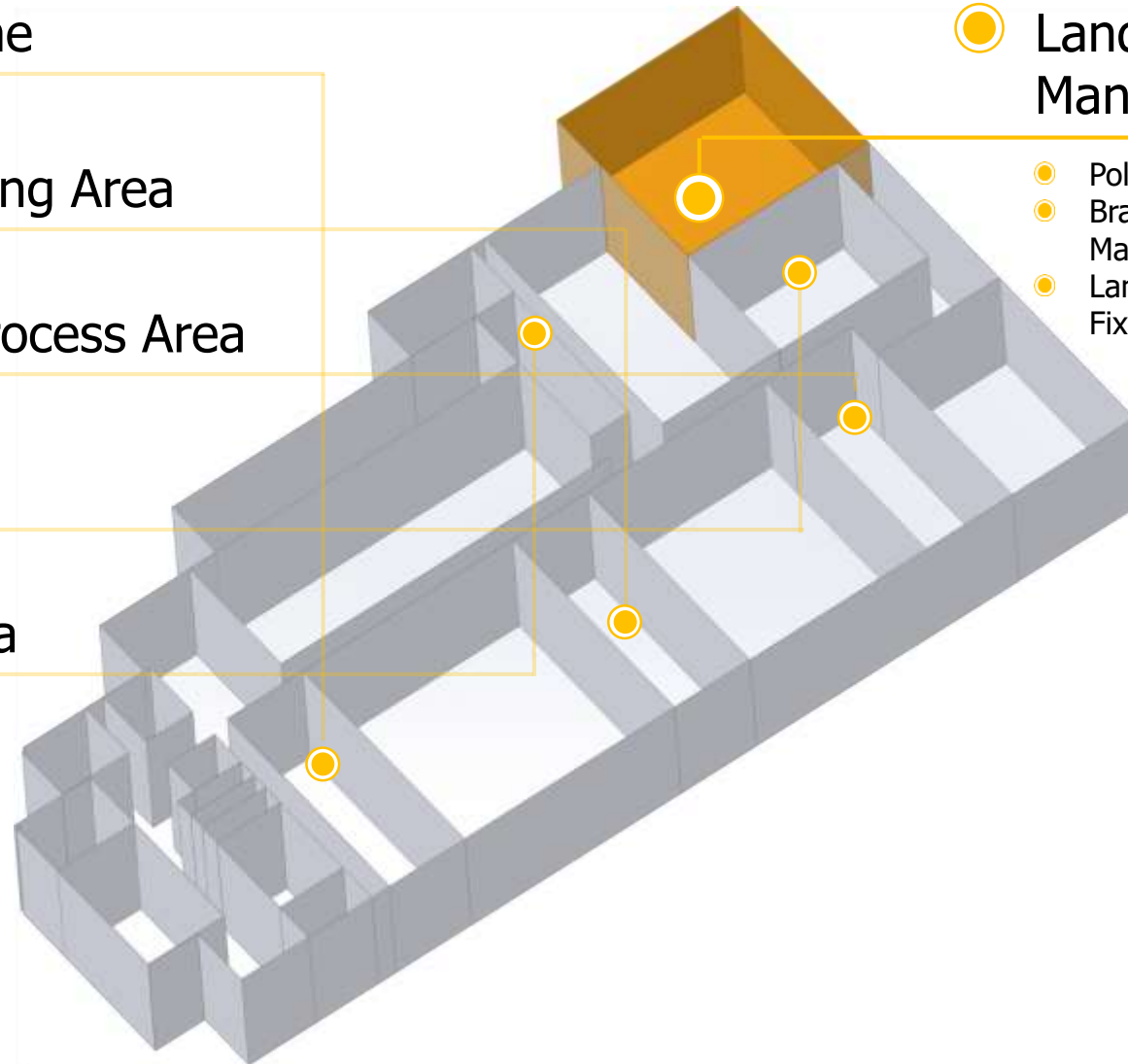

● Landscape Lighting Fixture Parts Manufacturing Area

- Pole Manufacturing
- Bracket and Street Fixture Parts Manufacturing
- Landscape, Bollards & Wall Fixture Parts Manufacturing,



Factory

● Electronic Assembly Line

● Plastic Injection Moulding Area

● Semi-finished Goods Process Area

● Moulding Area

● Diffuser Treatment Area

● Landscape Lighting Fixture Parts Manufacturing Area

● Fiber Glass Reinforced Polyester Product Manufacturing Area

- Waterproof Manufacturing
- Street Light Manufacturing
- Floodlight Manufacturing
- Gear Box Manufacturing

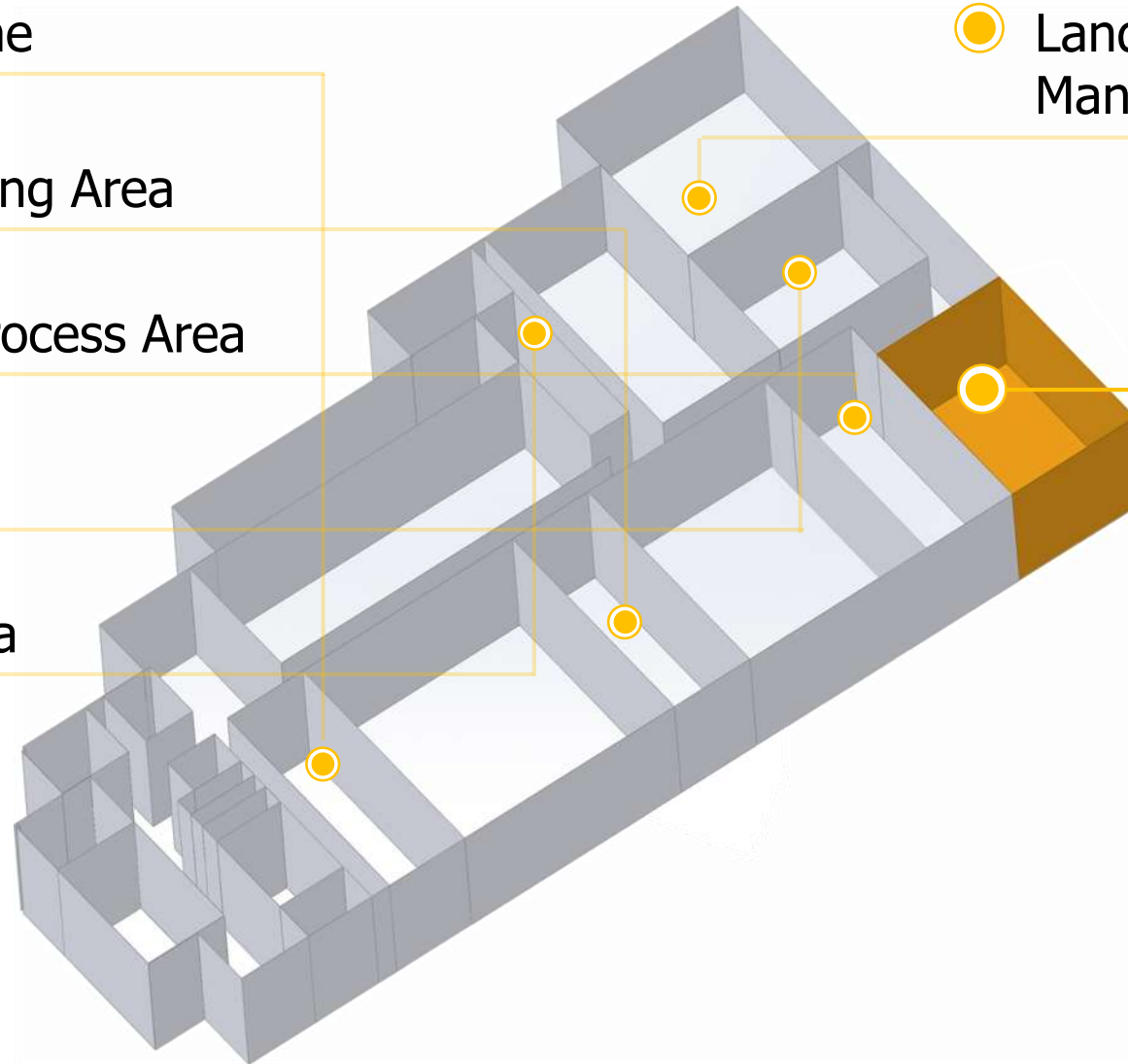

Factory

● Electronic Assembly Line

● Plastic Injection Moulding Area

● Semi-finished Goods Process Area

● Moulding Area

● Diffuser Treatment Area

● Landscape Lighting Fixture Parts Manufacturing Area

● Fiber Glass Reinforced Polyester Product Manufacturing Area

● Powder Coating & Painting Area

- 100mt Conveyor Line
- Auto-Robot System
- Phosphatization Pool
- Cleaning Pool

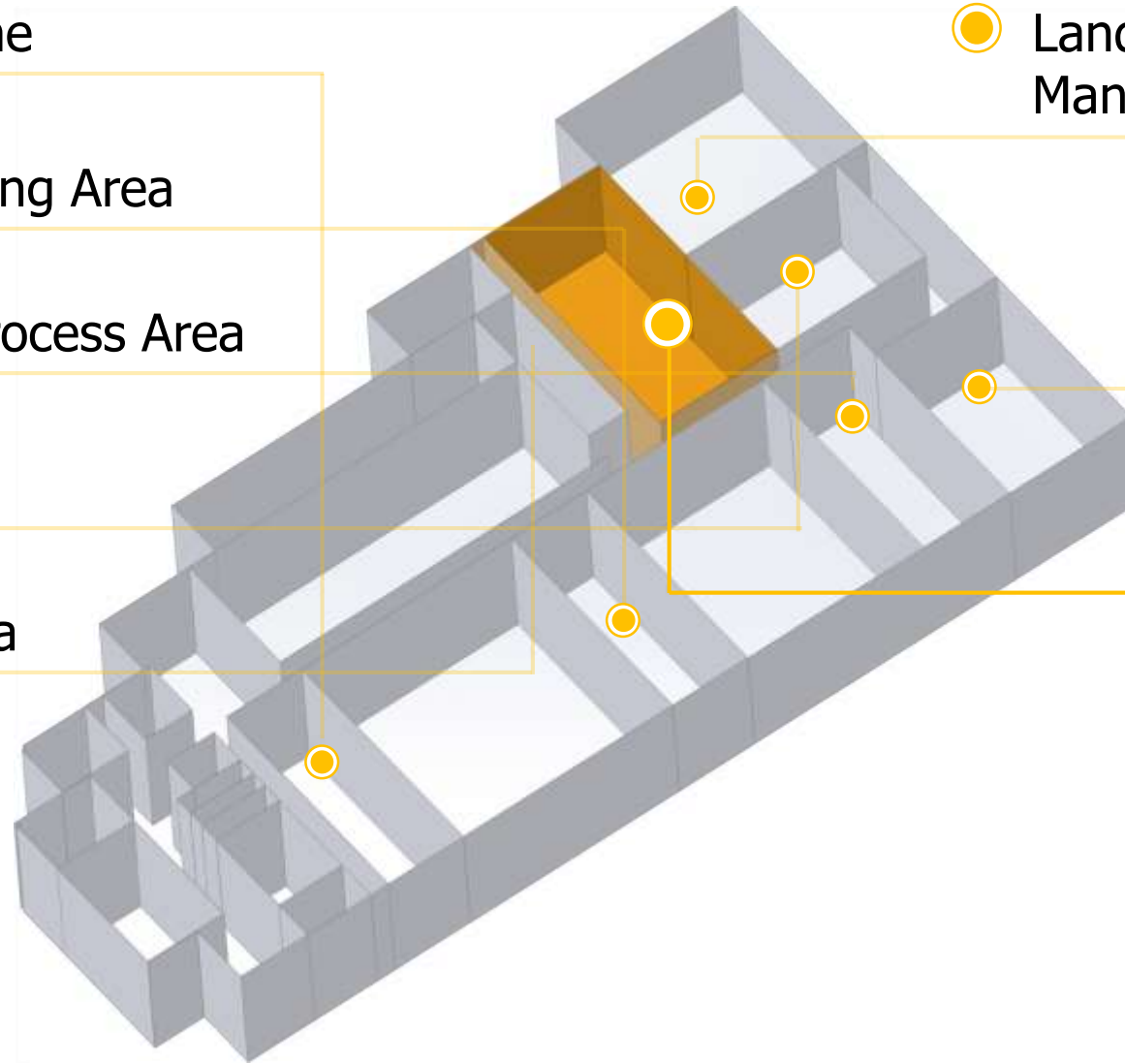

Factory

● Electronic Assembly Line

● Plastic Injection Moulding Area

● Semi-finished Goods Process Area

● Moulding Area

● Diffuser Treatment Area

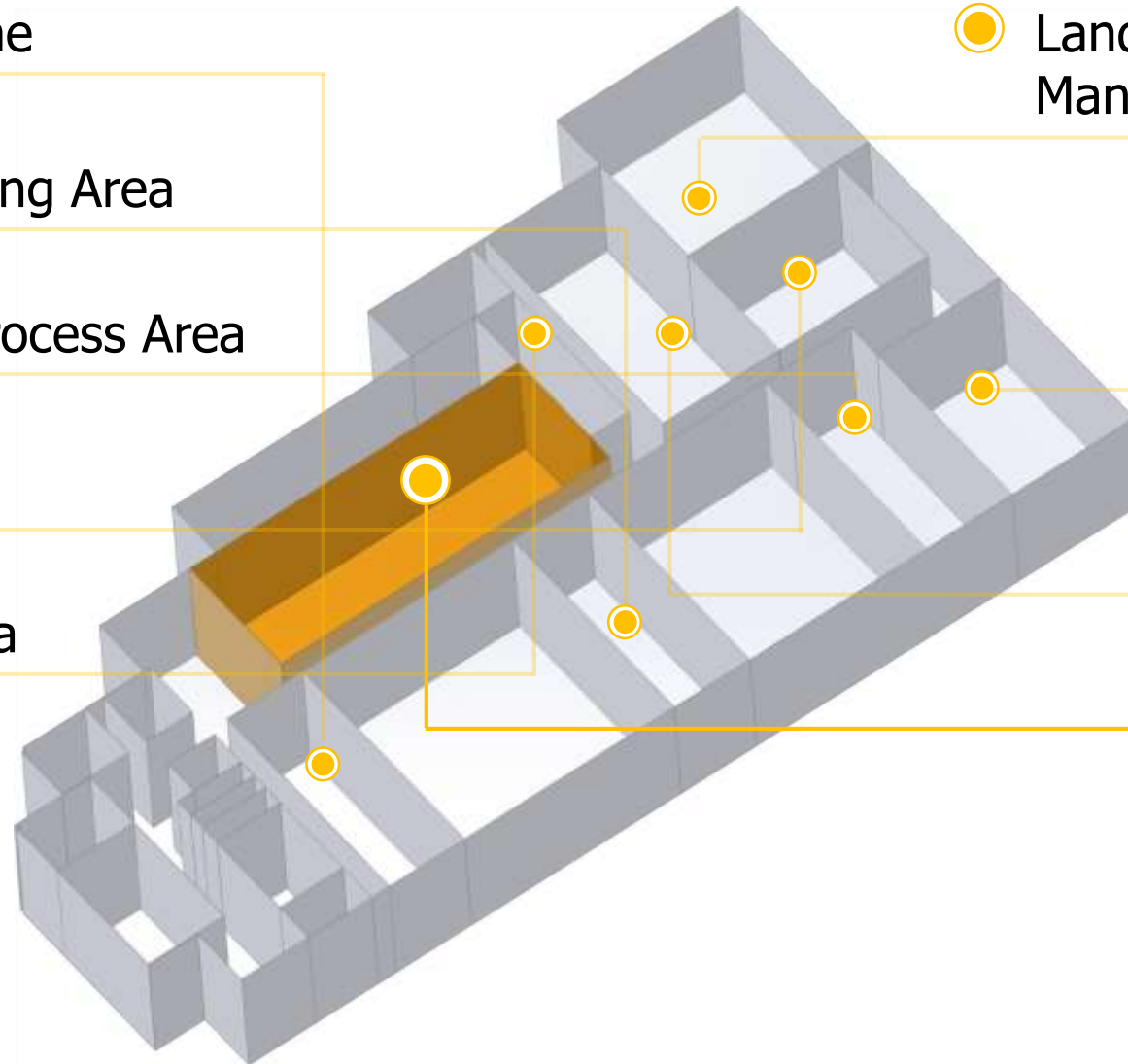

● Landscape Lighting Fixture Parts Manufacturing Area

● Fiber Glass Reinforced Polyester Product Manufacturing Area

● Powder Coating & Painting Area

● Assembly Line

- 9 Separated Belt Conveyor Assembly Lines
- Min. 2 Hours Life-time Test Unit per Line
- LVD & Function Test Systems for Each Lines



Factory

● Electronic Assembly Line

● Plastic Injection Moulding Area

● Semi-finished Goods Process Area

● Moulding Area

● Diffuser Treatment Area

● Landscape Lighting Fixture Parts Manufacturing Area

● Fiber Glass Reinforced Polyester Product Manufacturing Area

● Powder Coating & Painting Area

● Assembly Line

● Office

- Research & Development
- Planning & Scheduling
- Quality Assurance
- Purchasing
- Human Resources
- Management

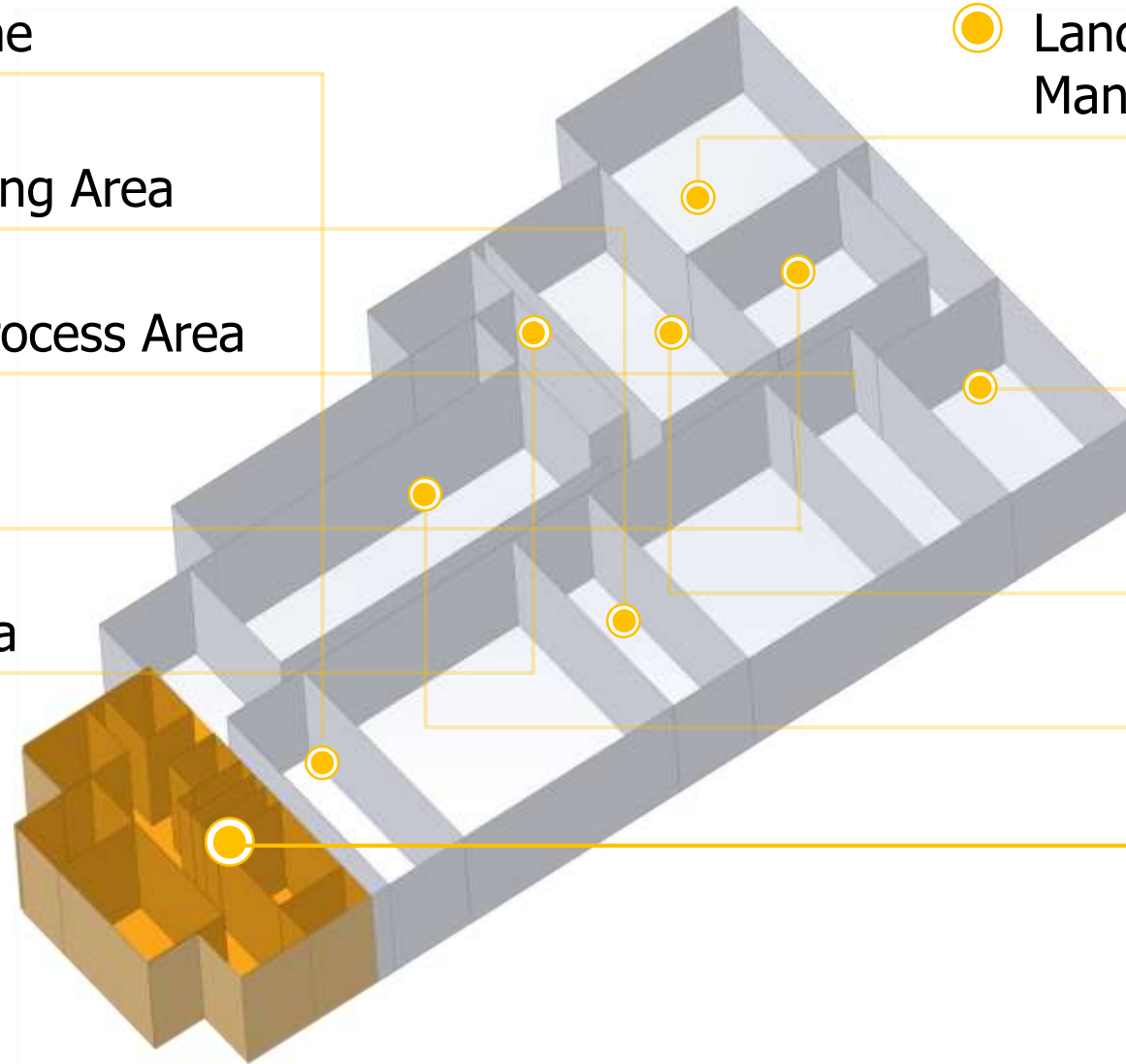

Factory

● Electronic Assembly Line

● Plastic Injection Moulding Area

● Semi-finished Goods Process Area

● Moulding Area

● Diffuser Treatment Area

● Landscape Lighting Fixture Parts Manufacturing Area

● Fiber Glass Reinforced Polyester Product Manufacturing Area

● Powder Coating & Painting Area

● Assembly Line

● Office

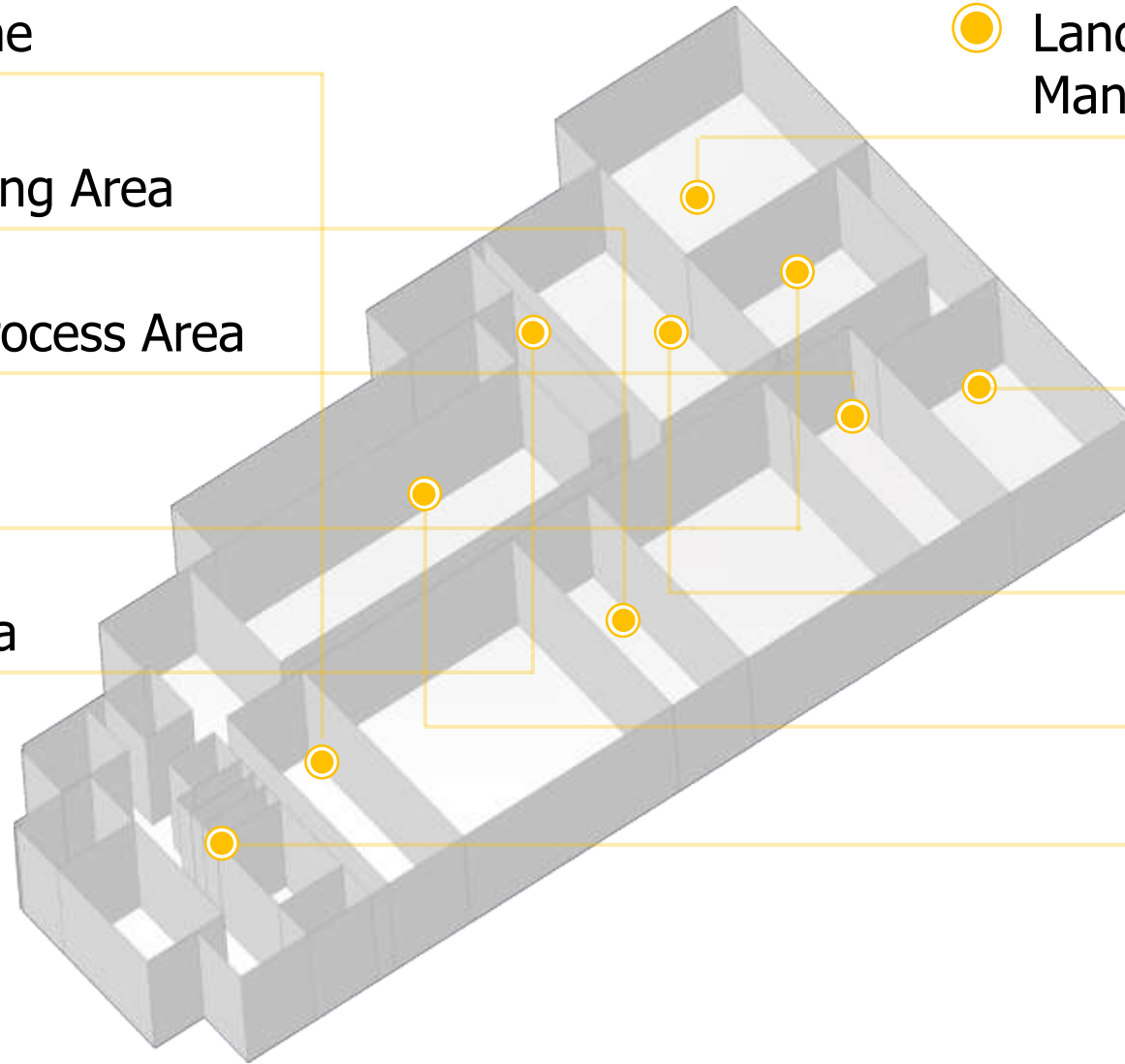

Product Range



Interior

Office Luminaires
Downlights
Spot Lights
Living Space Lighting
Linear Luminaires
LED Strips



Exterior

Road & Street Lighting
Floodlighting
Landscape Lighting
Wallwashers



Industrial

Waterproof Luminaires
LOW & HIGH Bay Luminaires
Continuous Line Lighting
School Luminaires
Canopy Luminaires



Ex-Proof

LOW & HIGH Bay Luminaires
Waterproof Luminaires
Canopy Luminaires
Road & Street Canopy Luminaires
Floodlighting



Emergency Lighting

Emergency and Exit Luminaires
Emergency Lighting Kits
Sensor LED Emergency Lighting



Lamp

LED Lamps
HP Sodium / Metal Lamps
LED Tubes



Components

Driver
EMG Converter Kit
Metal Halide/ Sodium Ballasts
PIR & Radar Sensors
Lamp Holders



Switch & Plug

Switch
Wall Plug – Socket Plug
Group Plugs



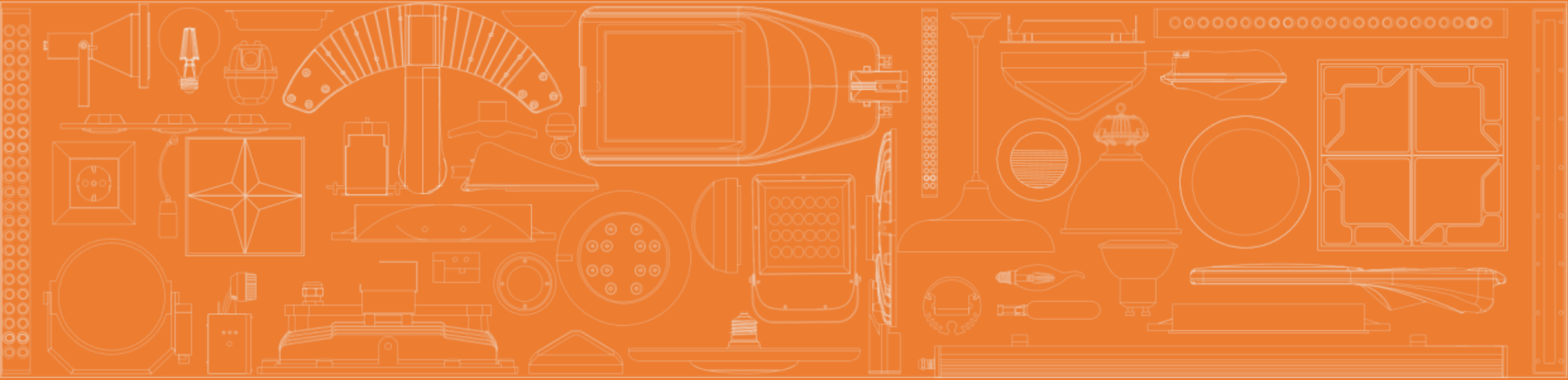

Global Network & References

Export

OEM

Local Market

Project Engineering

References





47

Export Countries



OEM

Italy

Denmark

Sweden

Poland

UK

Czech Republic

Germany

Holland

Portugal

Romania



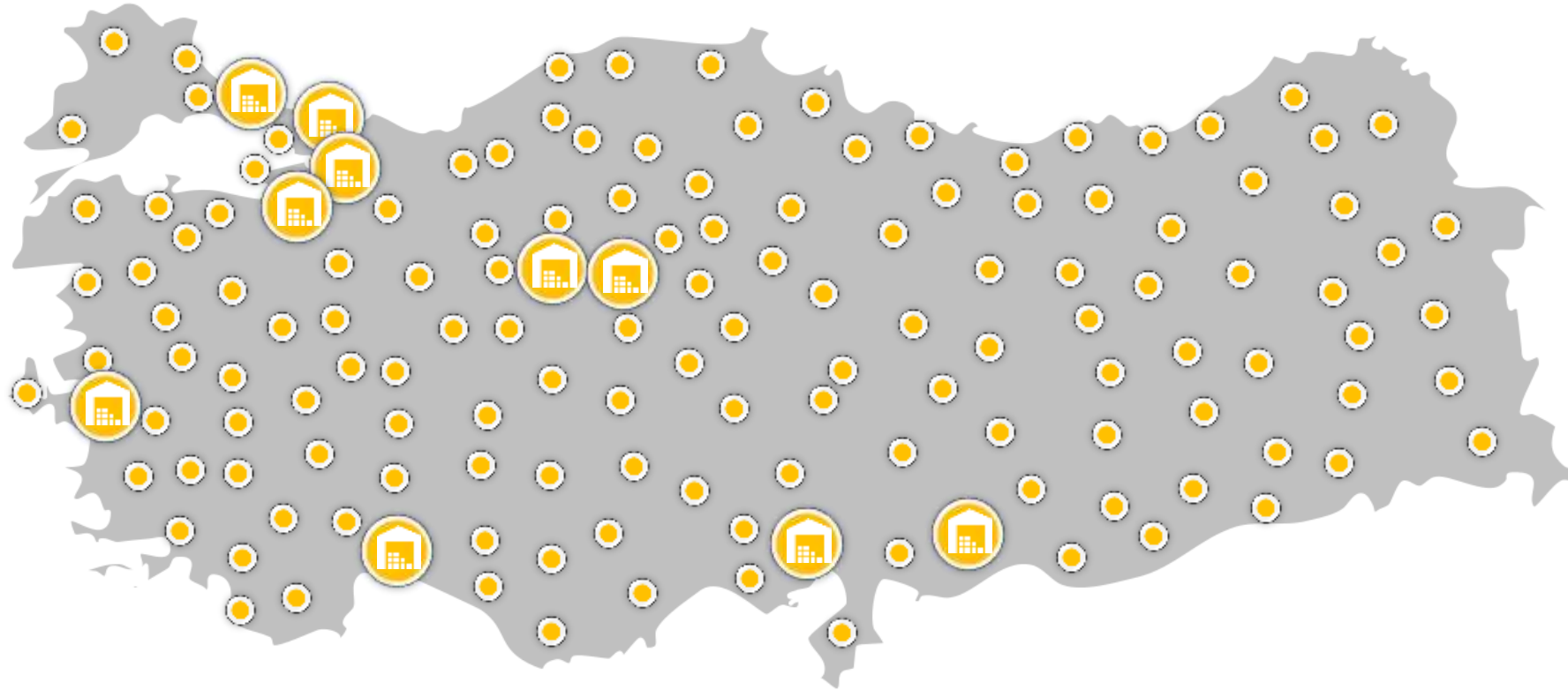

Wide Distribution Network all over Turkey



Project Engineering

Project Engineering Team Ensures Professional Solutions.

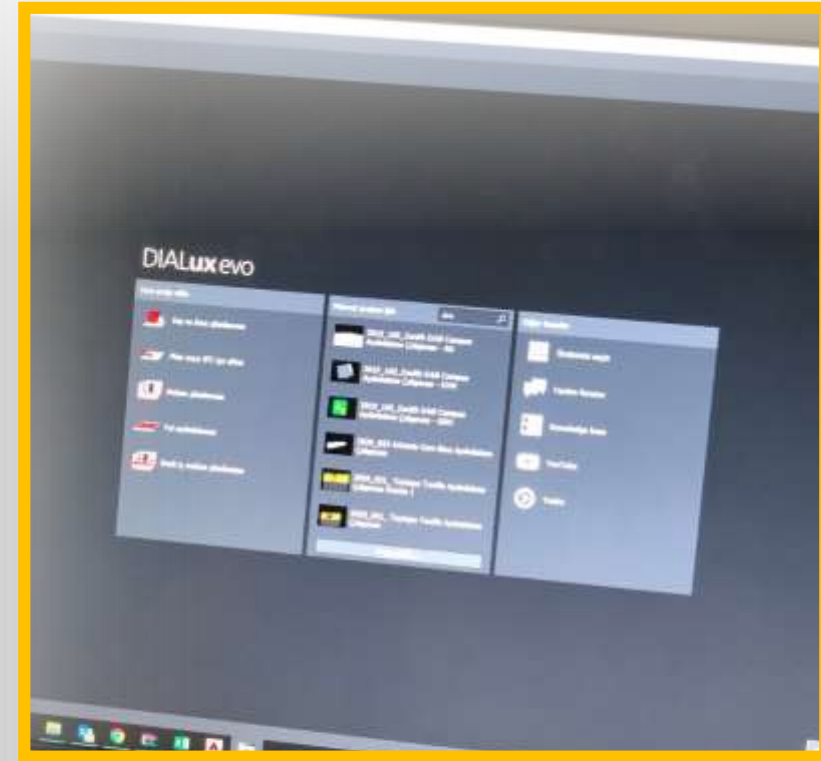
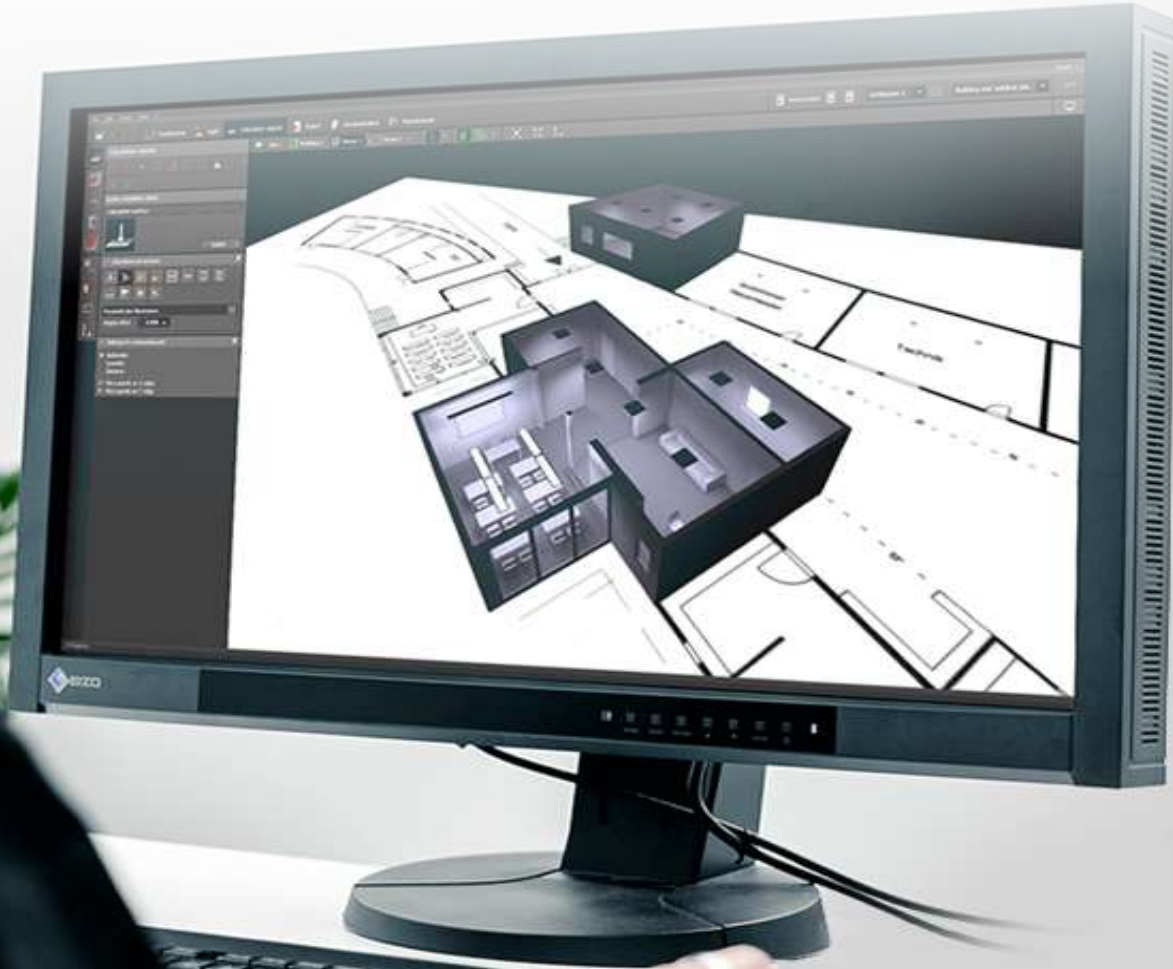

Project Engineering

Project Engineering Team Ensures Professional Solutions.

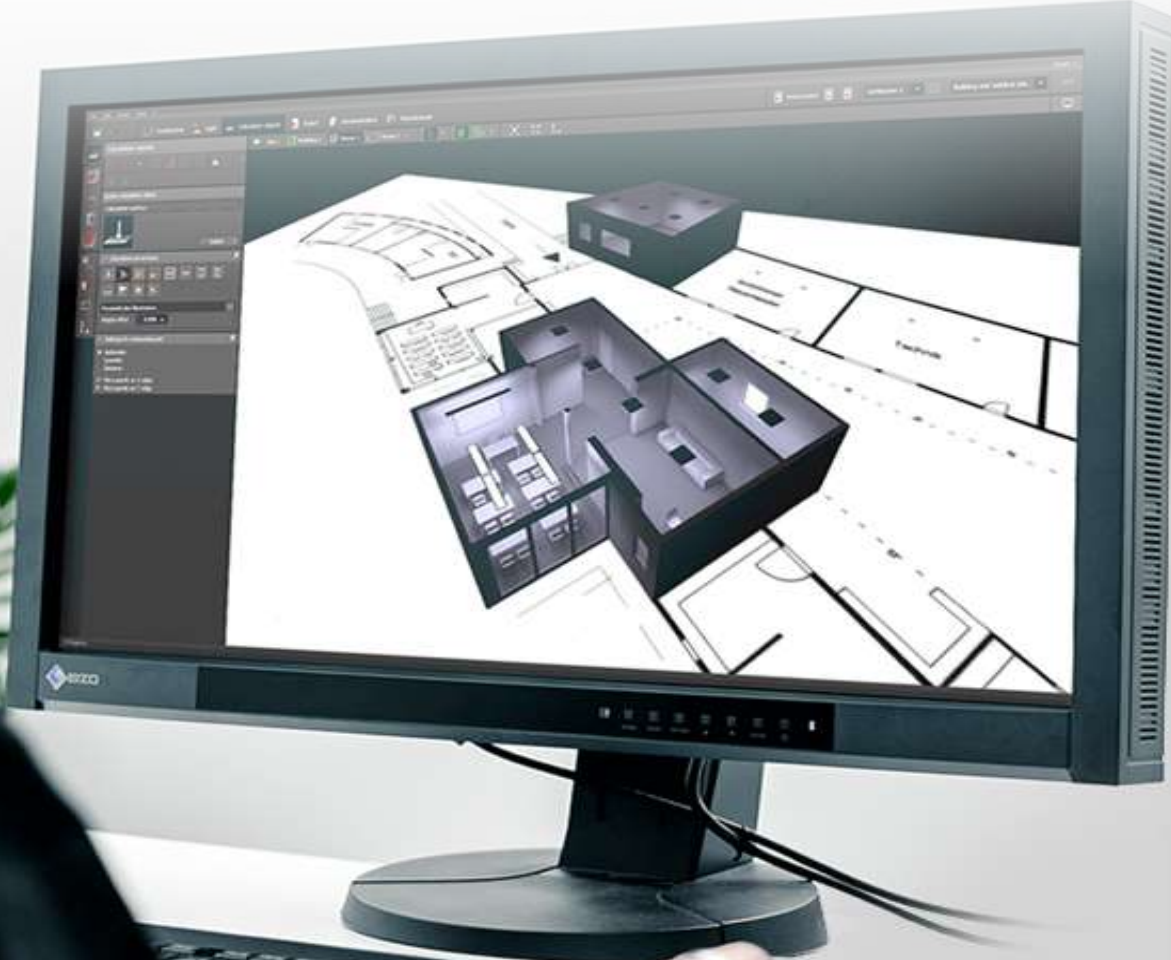

Metro Istanbul



İstanbul Ulaşım AŞ



Antalya Arena



Gaziantep Municipality

Projects with Highest Reputation



References

Metro Istanbul



References

Asghabat Int'l Airport



References

Kosovo Kastrati Fuel Stations

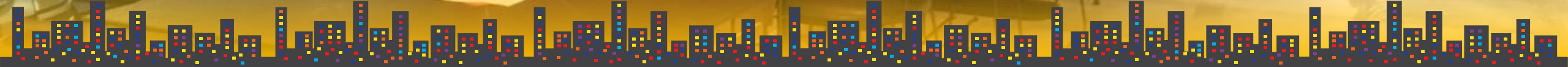

References

Opet Fuel Stations



References

Batum Tegeta Motors



References

Ađaođlu 1453 Maslak Residence



References

Batum Twin Tower



References

Erzincan Gold Mine



References

Samsung



References

Skoda



References

Doha Qatar



References

Cameroon Douala Japoma Stadium



References

Atatürk Closed Sport Complex

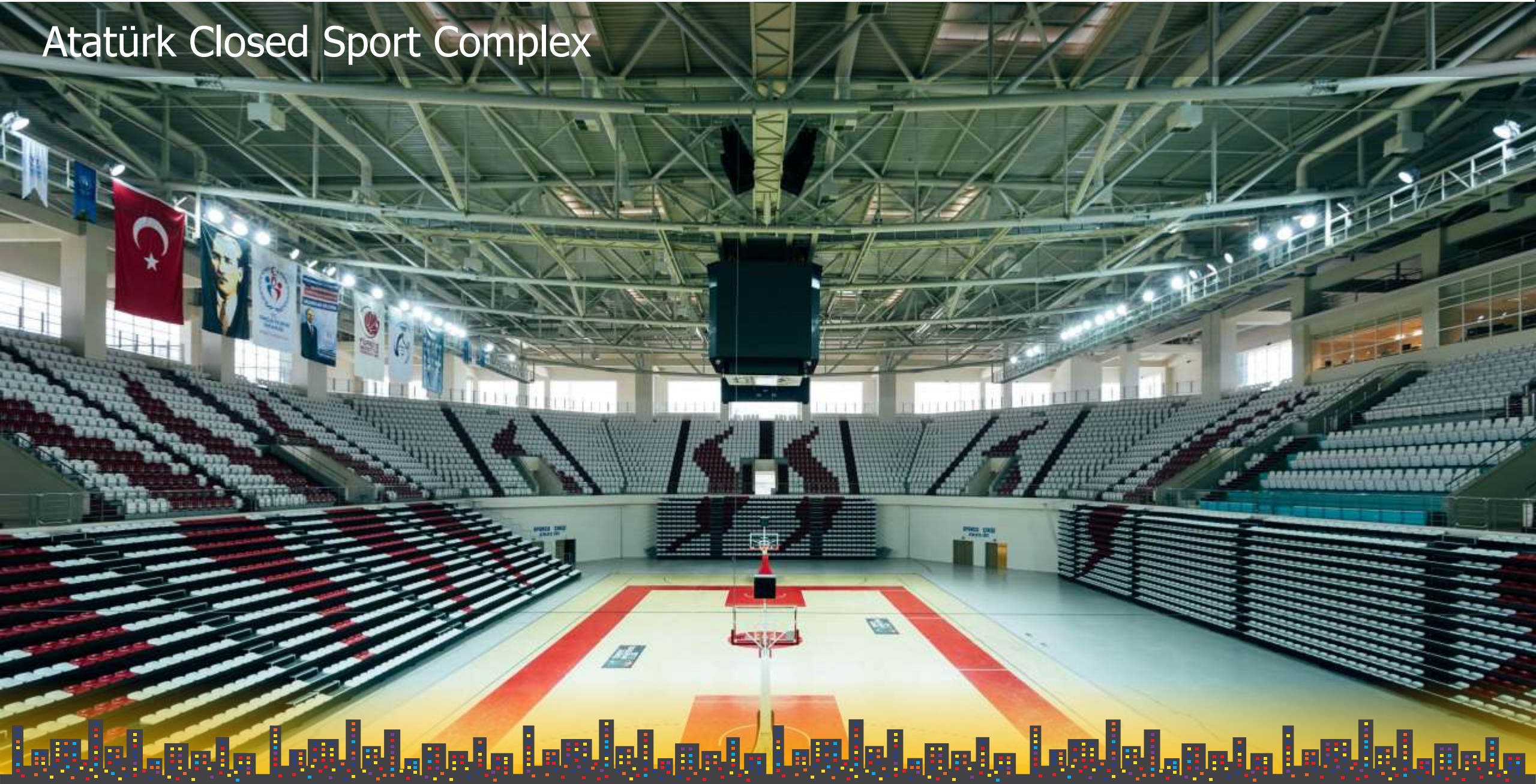

THANK YOU DANKE ARIGATÔ MERCI GRAZIE OBRIGADO TERIMA KASIH. DHANYAVÄD KÖSZÖNÖM SHUKRAN TAK KOP KHUN KIITOS NGIYABONGA HVALA XHALA



Pelsan

